

# AC/DC GEAR MOTOR

交直流减速电动机

CATALOGUE

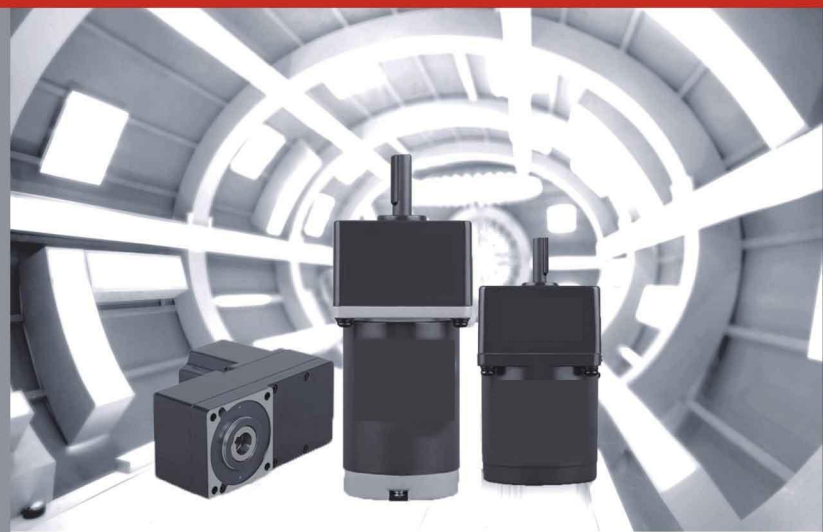

## DESCRIPTION OF MOTOR

## 电动机型号说明

5 1 K 40 R GN C T  
① ② ③ ④ ⑤ ⑥ ⑦ ⑧

①	电动机尺寸 Motor Frame Size	0:42mm 2:60mm 3: 70mm 4:80mm 5:90mm 6:104mm
②	类型名称 Motor Type	L:感应电机 Induction Motors R:可逆电动机 Reversible Motors T:转矩电机 Torque Motors
③	系列名称 Series	K: K系列 K Series
④	输出功率 Output Power(W)	(例. E.g.) 40: 40W
⑤	R标识带调速器电动机; 无: 表示未带 The Suffix "R" after the output power means speed adjustable motor.	
⑥	转轴形状 Motor Shaft Type	GN: GN型齿轮轴 GN Type Pinion Shaft GU: GU型齿轮轴 GU Type Pinion Shaft A: 圆轴型 Round Shaft A1: 键槽型 Keyway
⑦	电源电压、极数 Power Supply Voltage, Poles	A: 单相 Single-Phase 110V 50/60Hz 4p H: 单相 Single-Phase 220/230V 60Hz 4p B: 单相 Single-Phase 110V 50Hz 2p S: 三相 Three-Phase 200/220/230V 50/60Hz 4p C: 单相 Single-Phase 220/230V 50Hz 4p S3: 三相 Three-Phase 380/400/415V 50/60Hz 4p D: 单相 Single-Phase 220V 60Hz 2p T: 三相 Three-Phase 200/220/230V 50/60Hz 2p E: 单相 Single-Phase 110/120V 60Hz 4p T3: 三相 Three-Phase 380/400/415V 50/60Hz 2p
⑧	T: 带端子箱型 Terminal Box type F: 带风扇 W/Fan FF: 带强制冷却 W/Forced Fan M: 无励磁动作型电磁制动电动机 Power Off Activated Type Electromagnetic Brake Motor	

## DESCRIPTION OF MOTOR

## 减速器型号说明

5 GN 50 K RH  
① ② ③ ④ ⑤

①	减速器安装尺寸 Gear head Frame Size	0:42mm 2:60mm 3: 70mm 4:80mm 5:90mm 6:104mm
②	类型 Type of Pinion	GN: GN型齿轮轴 GN Type gear GU: GU型齿轮轴 GU Type gear
③	减速比 Gear Ratio	(例. E.g.) 50: 减速比 Gear Ratio of 1:50 10 × 仅指减速器 1: 10的中间减速比 10 × Denotes The Decimal Gearhead of Ratio 1:10
④	轴承类型 Bearing Type	K: 滚珠轴承 (对GU型方箱体标注为KB) Bearing(Mark KB for Type GU Square Case)
⑤	输出种类 Type of Output Shaft	RH: 蜗轮蜗杆空心轴输出 Hollow Worm Shaft RA: 蜗轮蜗杆实心轴输出 Worm Output Shaft RC: 圆锥齿空心轴输出 Spiral Bevel Hollow Shaft RT: 圆锥齿实心轴输出 Spiral Bevel Output Shaft
⑥	备注: 电机配平行轴减速器时第5项省略, 如配置角减速器时第四项省略 Note: if the motor assembly with parallel gearbox item No.5 shall be canceled. If assembly with right angle gearbox item No.4 shall be canceled.	

## 电动机的一般规格

## GENERAL SPECIFICATIONS OF MOTORS

## ■ 3W~200W型、2极·高速型 6W~150W、2P·High Speed

项目 Item	规格 Specifications
绝缘电阻 Insulation Resistance	于常温 常湿下的电动机额定运行后, 以DC500V电阻表测量线圈 外壳同时, 测量值为100MΩ以上 In the circumstance of normal temperature and humidity, the resistance can be up to 100MΩ, measured DC 500V insulation resistance measurer between the motor wiring and motor shell while the motor is working.
绝缘耐压 Insulation Voltage	于常温 常湿下电动机额定运行后, 在绕组 外壳间施加一分钟50Hz或60Hz, 1.5kV (三相400V为2kV) 的电压, 亦无异常 In the circumstance of normal temperature and humidity, there will be no problem supplying the power of 1.5kV(three phase:60V: 2kV) at 50/60Hz between the metal wiring and motor shell for 1 minute while the motor is working.
温度上升 Temperature Rise	在负载 减速度 同等或等效热耗*并于常温 常湿下进行额定运行时, 以电阻法测定其线圈温度上升值为80℃以下 (三相型为70℃以下) The temperature rise of winding are 80°C or less measured by the resistance change method after rated motor operation under normal ambient temperature and humidity, with connecting a gearhead or equivalent heat radiation plate.*
绝缘等级 Insulation Class	UL/CSA规格: A级 (105°C), EN规格: B级 (130°C) UL/CSA Standards: Class A(105°C) EN Standards: Class B(130°C)
过热保护装置 Overheat Protection	内藏热保护装置 (自动复位型) B种 (开放: 120°C±5°C, 75°C±15°C) F种 (开放: 145°C±5°C, 100°C±15°C) Thermal protector inside (automatic return) Class B (opening: 120°C±5°C, 75°C±15°C) Class F (opening: 145°C±5°C, 100°C±15°C)
使用环境温度 Ambient Temperature	单相100W、三相200V、10~50°C (无冻结) 其他电压: 10~40°C (无冻结) Single-Phase 100WAC, Three-Phase 200VAC: 10~40°C(NonFreezing) Others: 10~40°C(NonFreezing)
使用环境湿度 Ambient Humidity	85%以下 (无结露) ≤85% (Noncondensing)
保护等级 Protection Class	导线型 Lead wire type: IP20 带端子箱型 Terminal Box Type 单相 Single-phase 100/50/60Hz, 110/120V/60Hz, 220/230V/50Hz, 220/230V/60Hz 25W 180W Type: IP54 (不包括圆轴安装面 Excluding the installation surface of the round shaft type) 三相 Three-phase 200/220/230V/50/60Hz, 380/400/415V/50/60Hz 25W-180W Type: IP54 (不包括圆轴安装面 Excluding the installation surface of the round shaft type)

## ■ 散热板尺寸 (材质: 铝) Heat Radiation Plate(Material: Aluminum)

电动机类型 Motor Type	尺寸 Size	厚度 Thickness (mm)
3W Type	80X80	5
6W Type	115X115	
15W Type	125X125	
25W (2极·高速4K40型、4K60型) (2P·High-Speed 4K40 Type, 4K60 Type)	135X135	
40W、60W Type	165X165	
80W、80W、120W Type (2极·高速5K150型) (2P·High-Speed 5K150 Type)	200X200	
120W、140W、200W Type	230X230	





# 15W

交流减速电机 □70mm  
AC GEAR MOTOR

## 感应电动机参数 INDUCTION MOTOR SPECS

型号Model · 类型 Type		输出功率 Output power W	电压 Voltage V	频率 Frequency Hz	电流 Current A	启动转矩 Starting Torque mN·m	额定转矩 Rated Torque mN·m	额定转速 Rated Speed r/min	电容器容量 Capacitor μF
齿轮轴型 Pinion Shaft	圆轴型 Round Shaft								
3K15G-A	3K15A-A	15	1ph 100	50	0.35	90	125	1200	6.0
				60	0.33	85	105	1450	
				1ph 120	60	0.32	65	105	
3K15G-C	3K15A-C	15	1ph 220	50	0.18	90	125	1200	1.2
				60	0.20	85	105	1450	
				1ph 230	60	0.16	65	105	
3K15G-H	3K15A-H	15	1ph 230	60	0.15	70	105	1450	-
				50	0.14	220	125	1200	
				60	0.12	180	105	1450	
3K15G-S	3K15A-S	15	3ph 220	50	0.14	220	125	1200	-
				60	0.12	180	105	1450	

## 可逆/刹车电动机参数 REVERSIBLE MOTOR SPECS

型号Model · 类型 Type		输出功率 Output power W	电压 Voltage V	频率 Frequency Hz	电流 Current A	启动转矩 Starting Torque mN·m	额定转矩 Rated Torque mN·m	额定转速 Rated Speed r/min	电容器容量 Capacitor μF
齿轮轴型 Pinion Shaft	圆轴型 Round Shaft								
3K15G-A	3K15A-A	15	1ph 100	50	0.40	110	125	1200	7.0
				60	0.56	105	105	1450	
				1ph 120	60	0.42	85	105	
3K15G-E	3K15A-E	15	1ph 110	50	0.43	85	105	1450	6.0
				60	0.42	85	105	1450	
				1ph 120	60	0.42	85	105	
3K15G-C	3K15A-C	15	1ph 220	50	0.23	110	125	1200	1.5
				60	0.20	85	105	1450	
				1ph 230	60	0.20	90	105	
3K15G-H	3K15A-H	15	1ph 230	60	0.20	90	105	1450	1.5

## 调速电动机参数 SPEED CONTROL MOTOR SPECS

型号Model · 类型 Type		最大 输出功率 Output power W	电压 Voltage V	频率 Frequency Hz	调速范围 Speed Control Range r/min	容许转矩 Allowance Torque		启动转矩 Starting Torque mN·m	电流 Current A	电容器容量 Capacitor μF
齿轮轴型 Pinion Shaft	圆轴型 Round Shaft					1200/min mN·m	900/min mN·m			
3K15RG-A	3K15RA-A	15	1ph 100	50	90-1350	120	35	55	0.35	6.0
				60	90-1650	120	35	55	0.33	
				1ph 110	60	90-1650	125	35	55	
3K15RG-E	3K15RA-E	15	1ph 120	60	90-1650	125	35	55	0.32	5.0
				50	90-1350	120	35	54	0.18	
				1ph 230	60	90-1650	120	35	54	
3K15RG-C	3K15RA-C	15	1ph 220	50	90-1350	120	35	54	0.16	1.2
				60	90-1650	85	35	52	0.16	
				1ph 230	60	90-1650	105	35	55	
3K15RG-H	3K15RA-H	15	1ph 230	60	90-1650	105	35	55	0.15	1.2

## ■ 装有减速器时的容许转矩 Gear Motor-Torque Table

- 减速器另售 中间减速器另售。  
Gearhead and mid-gearbox can be sold separately.
- 减速器型号的□中为减速化的数值。  
Enter the gear ratio in the box (□) within the model name.
- 颜色表示与电动机同一方向运转, 其他则为相反方向。  
The colored background ■ indicates the same rotating direction of the motor while the rotating direction of others are opposite.

## 容许力矩单位 Allowance Torque Unit : 上段 Upside ( N.m ) / 下段 Belowside ( kgf.cm )

类型 Type 电动机/减速机 Motor/Gearhead	减速比 Gear Ratio	容许力矩																					
		3	3.6	5	6	7.5	9	12.5	15	18	25	30	36	50	60	75	90	100	120	150	180	200	
3K15GN-A 3K15GN-E 3K15GN-C 3K15GN-H 3K15GN-S	50Hz	500	417	300	250	200	166	120	100	83	60	50	41	30	25	20	16	15	12.5	10	8.3	7.5	
		60Hz	600	500	360	300	240	200	144	120	100	72	60	50	36	30	24	20	18	15	12	10	9
	50Hz	0.30	0.36	0.51	0.61	0.76	0.91	1.3	1.5	1.8	2.3	2.7	3.3	4.1	5	5	5	5	5	5	5	5	5
		3.06	3.67	5.20	6.22	7.75	9.28	13.2	15.3	18.3	23.4	27.5	33.7	41.8	50	50	50	50	50	50	50	50	50
	60Hz	0.26	0.31	0.43	0.51	0.64	0.77	1.1	1.3	1.5	1.9	2.3	2.8	3.5	4.2	5	5	5	5	5	5	5	5
		2.65	3.16	4.38	5.20	6.53	7.85	11.2	13.2	15.3	19.3	23.4	28.5	35.7	42.8	50	50	50	50	50	50	50	50

## ■ 外形图 (单位 mm) Dimensions (Unit mm)

减速器附有安装用螺丝 Mounting screws are included with gearhead.

- 导线型 Lead Wiring Type (感应/可逆 Induction/Reversible Motor)  
重量 Weight : 电动机 Motor : 1.47kg 减速器 Gearhead : 0.5kg



- 导线型 Lead Wiring Type (刹车 Brake Motors)  
重量 Weight : 电动机 Motor : 1.47kg 减速器 Gearhead : 0.5kg

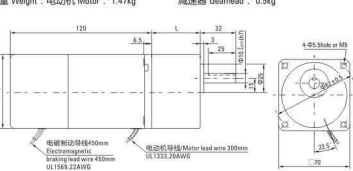

- 导线型 Lead Wiring Type (调速 Speed Control Motors)  
重量 Weight : 电动机 Motor : 1.2kg 减速器 Gearhead : 0.5kg

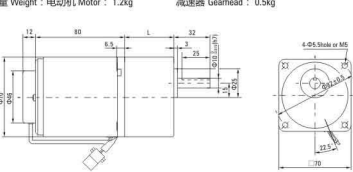

- 圆轴型的轴部分 Shaft Section Of Round Shaft Type

除重量及轴部外电动机外形与齿轮轴型相同。  
Excluding weight and the shaft section motor shape are the same as those of the pinion shaft type.

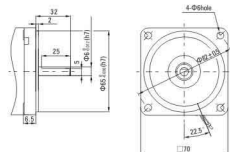

- 中国减速机 Decimal Gearhead

可安装在GN轴型上 Can be connected to GN pinion shaft type  
电动机外形与齿轮轴型相同  
Motor shape is the same as the pinion shaft type

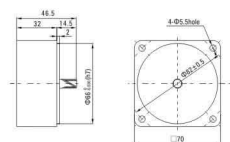

减速器型号 Gearhead Model	减速比 Gear Ratio	L1
3GN□K	3-18	32
	25-200	42

- 减速器型号的□中为减速化的数值  
Enter the gear ratio in the box (□) within the model name



# 25W

交流减速电机 □80mm  
AC GEAR MOTOR

### 感应电动机参数 INDUCTION MOTOR SPECS

型号Model · 类型Type 上段 齿轴轴 Upper Pinion Shaft 下段 内齿轴 Below Round Shaft	输出功率 Output power	电压 Voltage	频率 Frequency	电流 Current	启动转矩 Starting Torque	额定转矩 Rated Torque	额定转速 Rated Speed	电容器容量 Capacitor	
导线型 Lead Wire Type 外形图Dimensions①	端子箱型 Terminal Box Type 外形图Dimensions②	W	V	Hz	A	mN·m	r/min	μF	
4K25GN-A (4K25A-A)	4K25GN-AT (4K25A-AT)	25	1ph 100	50	0.50	120	200	1250	8.0
				60	0.55	165	1550		
4K25GN-E (4K25A-E)	4K25GN-ET (4K25A-ET)	25	1ph 110	50	0.45	120	165	1550	7.0
				60	0.50	165	1550		
4K25GN-C (4K25A-C)	4K25GN-CT (4K25A-CT)	25	1ph 120	50	0.25	120	200	1250	1.8
				60	0.23	120	200		
4K25GN-H (4K25A-H)	4K25GN-HT (4K25A-HT)	25	1ph 230	50	0.23	120	165	1550	1.8
				60	0.23	120	165		
4K25GN-S (4K25A-S)	4K25GN-ST (4K25A-ST)	25	3ph 220	50	0.185	350	200	1250	-
				60	0.170	250	165		

### 可逆/刹车电动机参数 REVERSIBLE MOTOR SPECS

型号Model · 类型Type 上段 齿轴轴 Upper Pinion Shaft 下段 内齿轴 Below Round Shaft	输出功率 Output power	电压 Voltage	频率 Frequency	电流 Current	启动转矩 Starting Torque	额定转矩 Rated Torque	额定转速 Rated Speed	电容器容量 Capacitor	
导线型 Lead Wire Type 外形图Dimensions①	端子箱型 Terminal Box Type 外形图Dimensions②	W	V	Hz	A	mN·m	r/min	μF	
4K25GN-A (4K25A-A)	4K25GN-AT (4K25A-AT)	25	1ph 100	50	0.59	160	200	1250	10.0
				60	0.69	140	165	1550	
4K25GN-E (4K25A-E)	4K25GN-ET (4K25A-ET)	25	1ph 110	50	0.45	140	165	1550	8.0
				60	0.50	140	165		
4K25GN-C (4K25A-C)	4K25GN-CT (4K25A-CT)	25	1ph 120	50	0.29	140	200	1250	2.2
				60	0.30	160	200		
4K25GN-H (4K25A-H)	4K25GN-HT (4K25A-HT)	25	1ph 230	50	0.35	140	165	1550	2.2
				60	0.35	140	165		

### 调速电动机参数 SPEED CONTROL MOTOR SPECS

型号Model · 类型Type 导线型 Lead Wire Type	最大输出功率 Output power W	电压 Voltage V	频率 Frequency Hz	调速范围 Speed Control Range r/min	容许转矩		启动转矩 Starting Torque mN·m	电流 Current A	电容器容量 Capacitor μF
					1200/mN·m	90°/mm mN·m			
4K25RG-A (4K25RA-A)	25	1ph 100	60	90-1350	190	47	88	0.50	8.0
4K25RG-E (4K25RA-E)	25	1ph 110	60	90-1650	190	50	105	0.50	7.0
4K25RG-C (4K25RA-C)	25	1ph 230	50	90-1350	190	47	88	0.25	1.8
4K25RG-H (4K25RA-H)	25	1ph 230	60	90-1650	190	45	88	0.23	1.8

### ■ 装有减速器时的容许转矩 Gear Motor-Torque Table

- 减速器另售 中心减速器另售。  
Gearhead and mid-gearbox can be sold separately.
- 减速器型号的二者为减速比的数值。  
Enter the gear ratio in the box (□) within the model name.
- □表示与电动机同一方向旋转，其他则为相反方向。  
The colored background □□ indicates the same rotating direction of the motor while the rotating direction of others are opposite.

容许力矩单位 Allowance Torque Unit : 上段 Upside ( N·m ) / 下段 Belowside ( kgf·cm )

类型 Type 电动机/Gearhead Motor/Gearhead	减速比 Gear Ratio	3	3.6	5	6	7.5	9	12.5	15	18	25	30	36	50	60	75	90	100	120	150	180	200		
		转速 Speed r/min	50Hz	600	500	360	300	240	200	144	120	100	72	60	41	30	25	20	16	15	12.5	10	8.3	7.5
4K25GN-A □ 4K25GN-E □ 4K25GN-C □ 4K25GN-H □ 4K25GN-S □	4GN □	50Hz	0.49	0.58	0.81	0.97	1.2	1.5	2.0	2.4	2.9	3.7	4.4	5.3	6.6	7.9	8	8	8	8	8	8	8	8
		60Hz	5.00	5.91	8.26	9.89	12.2	15.3	20.4	24.4	29.6	37.7	44.9	54.1	67.3	80	80	80	80	80	80	80	80	80
		60Hz	0.40	0.48	0.67	0.80	1.0	1.2	1.7	2.0	2.4	3.0	3.6	4.3	5.4	6.5	8	8	8	8	8	8	8	8
	4GN □	60Hz	4.08	4.89	6.83	8.16	10.2	12.2	17.3	20.4	24.4	30.6	36.7	43.8	55.1	66.3	80	80	80	80	80	80	80	80

### ■ 外形图 (单位 mm) Dimensions (Unit mm)

减速器附有安装用螺丝 Mounting screws are included with gearhead.

- 导线型 Lead Wiring Type (感应/可逆 Induction/Reversible Motor)  
重量 Weight : 电动机 Motor : 1.8kg 减速器 Gearhead : 0.85kg

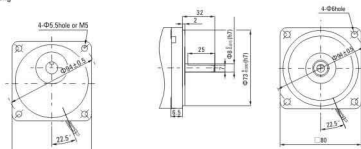
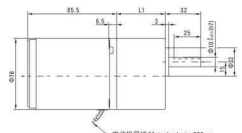

- 导线型 Lead Wiring Type (刹车 Brake Motors)  
重量 Weight : 电动机 Motor : 2.1kg 减速器 Gearhead : 0.8kg

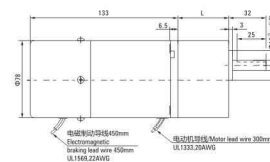

- 导线型 Lead Wiring Type (调速 Speed Control Motors)  
重量 Weight : 电动机 Motor : 1.7kg 减速器 Gearhead : 0.8kg

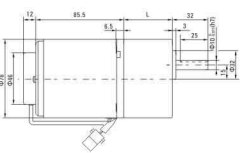

减速器型号 Gearhead Model	减速比 Gear Ratio	L1
4GN □	3-18	32
	25-200	43.5

- 减速器型号的 □ 中为减速比的数值  
Enter the gear ratio in the box (□) within the model name

● 带端子箱型 Terminal Box Type (感应/可逆Induction/Reversible Motor)  
重量 Weight : 电动机 Motor : 1.70kg 减速机 Gearhead : 0.8kg

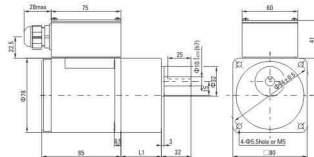

减速机型号 Gearhead Model	减速比 Gear Ratio	L1
4GN□K	3-18	32
	25-200	43.5

● 减速机型号的□中为减速比的数值  
Enter the gear ratio in the box (□) within the model name

## 弧锥直角 SPIRAL BEVEL RIGHT ANGLE

容许力矩单位 Allowance Torque Unit: 上段 Upside (N.m) / 下段 Belowside (kgf.cm)

机型Type	减速比Gear Ratio	3	3.6	5	6	7.5	9	12.5	15	18	25	30	36	50	60	75	90	100	120	150	180	
电动机/减速机 Motor/Gearhead	转速Speed r/min	50Hz	500	417	300	250	200	166	120	100	83	60	50	42	30	25	20	16	15	12	10	8
		60Hz	600	500	360	300	240	200	144	120	100	72	60	50	36	30	24	20	18	15	12	10
4K25GN-A□ 4K25GN-E□ 4K25GN-C□ 4K25GN-H□ 4K25GN-S□	容许力矩 Allowance Torque	50Hz	0.36	0.43	0.59	0.71	0.99	1.18	1.64	1.97	2.37	3.29	3.95	4.73	6.58	7.10	8.00	8.00	8.00	8.00	8.00	8.00
		60Hz	3.62	4.35	6.04	7.25	10.1	12.1	16.8	20.1	24.2	33.5	40.3	48.3	67.1	72.5	80.0	80.0	80.0	80.0	80.0	80.0
		60Hz	0.29	0.34	0.48	0.57	0.80	0.95	1.33	1.59	1.91	2.65	3.18	3.82	5.30	5.73	7.16	8.00	8.00	8.00	8.00	8.00
		60Hz	2.92	3.51	4.87	5.84	8.12	9.74	13.5	16.2	19.5	27.1	32.5	39.0	54.1	58.4	73.0	80.0	80.0	80.0	80.0	80.0

## ■ 感应尺寸图 Induction Type Drawing

4K25GN-A□/4GN□RC 4K25GN-C□/4GN□RT 4K25GN-E□/4GN□RC 4K25GN-H□/4GN□RT 4K25GN-S□/4GN□RC  
4K25GN-A□/4GN□RC 4K25GN-H□/4GN□RC 4K25GN-S□/4GN□RC 4K25GN-E□/4GN□RT 4K25GN-H□/4GN□RT 4K25GN-S□/4GN□RC

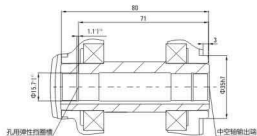
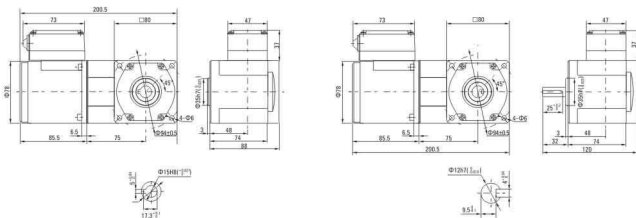

# 40W

交流减速电机 □90mm  
AC GEAR MOTOR

## ■ 感应电动机参数 INDUCTION MOTOR SPECS

型号Model - 类型 Type	输出功率 Output power	电压 Voltage	频率 Frequency	电流 Current	启动转矩 Starting Torque	额定转矩 Rated Torque	额定转速 Rated Speed	电容器容量 Capacitor
上段:齿轴轴 Upper-Pinion Shaft 下段:内齿轴轴 Below-Round Shaft	W	V	Hz	A	mN.m	mN.m	r/min	μF
导线型 Lead Wire Type 外形尺寸Dimensions①								
5K40GN-A (5K40A-A)	40	1ph 100	50	0.65	315	1250	12.0	-
			60	0.70	270	260	1550	
5K40GN-E (5K40A-E)	40	1ph 110	60	0.55	200	260	1550	8.0
		1ph 120	60	0.60	200	260	1550	
5K40GN-C (5K40A-C)	40	1ph 220	50	0.35	220	315	1250	2.5
		1ph 230	50	0.40	220	315	1250	
5K40GN-H (5K40A-H)	40	1ph 230	60	0.40	200	260	1550	-
		1ph 230	60	0.40	200	260	1550	
5K40GN-S (5K40A-S)	40	3ph 220	50	0.30	800	315	1250	-
		5K40GN-ST (5K40A-ST)	60	0.25	660	250	1550	

## ■ 可逆/刹车电动机参数 REVERSIBLE MOTOR SPECS

型号Model - 类型 Type	输出功率 Output power	电压 Voltage	频率 Frequency	电流 Current	启动转矩 Starting Torque	额定转矩 Rated Torque	额定转速 Rated Speed	电容器容量 Capacitor
上段:齿轴轴 Upper-Pinion Shaft 下段:内齿轴轴 Below-Round Shaft	W	V	Hz	A	mN.m	mN.m	r/min	μF
导线型 Lead Wire Type 外形尺寸Dimensions①								
5K40GN-A (5K40A-A)	40	1ph 100	50	0.78	300	315	1250	15.0
			60	1.05	260	260	1550	
5K40GN-E (5K40A-E)	40	1ph 110	60	0.79	260	260	1550	12.0
		1ph 120	60	0.89	260	260	1550	
5K40GN-C (5K40A-C)	40	1ph 220	50	0.45	270	315	1250	3
		1ph 230	50	0.45	270	315	1250	
5K40GN-H (5K40A-H)	40	1ph 220	60	0.45	270	260	1550	3
		1ph 230	60	0.45	270	260	1550	

## ■ 调速电动机参数 SPEED CONTROL MOTOR SPECS

型号Model - 类型 Type	最大 输出 功率 Output power	电压 Voltage	频率 Frequency	调速范围 Speed Control Range	容许转矩 Allowance Torque	启动转矩 Starting Torque	电流 Current	电容器容量 Capacitor
齿轮轴型 Pinion Shaft	W	V	Hz	r/min	1200r/min mN.m	90r/min mN.m	mN.m	μF
圆轴型 Round Shaft								
5K40RN-A	40	1ph 100	50	90-1350	260	70	180	12.0
			60	90-1650	260	65	180	
5K40RN-E	40	1ph 110	60	90-1650	260	70	180	8.0
		1ph 120	60	90-1650	260	65	180	
5K40RN-C	40	1ph 220	50	90-1350	300	75	160	2.5
		1ph 230	50	90-1350	300	75	160	
5K40RN-H	40	1ph 220	60	90-1650	230	70	145	2.5
		1ph 230	60	90-1650	230	70	145	

### ■ 装有减速器时的容许转矩 Gear Motor-Torque Table

- 减速器另售(中间减速器另售)。

Gearhead and mid-gearbox can be sold separately.

- 减速品型号的□中为减速比的数值。

Enter the gear ratio in the box (□) within the model name.

- □□色表示与电动机同一方向旋转, 其他则为相反方向。

The colored background □□ indicates the same rotating direction of the motor while the rotating direction of others are opposite.

### 容许力矩单位 Allowance Torque Unit: 上段 Upside (N.m) / 下段 Belowside (kgf.cm)

类型 Type 电动机/减速器 Motor/Gearhead	减速比 Gear Ratio	容许力矩 Allowance Torque																				
		3	3.6	5	6	7.5	9	12.5	15	18	25	30	36	50	60	75	90	100	120	150	180	200
SIK40GN-A□ SIK40GN-E□ SIK40GN-C□ SIK40GN-H□ SIK40GN-S□	50Hz	500	417	300	250	200	166	120	100	83	60	50	41	30	25	20	16	15	12.5	10	8.3	7.5
		600	500	360	300	240	200	144	120	100	72	60	50	36	30	24	20	18	15	12	10	9
SIK40GN-A□ SIK40GN-E□ SIK40GN-C□ SIK40GN-H□ SIK40GN-S□	60Hz	0.77	0.92	1.3	1.5	1.9	2.3	3.2	3.8	4.6	5.7	6.9	8.3	10	10	10	10	10	10	10	10	10
		7.85	9.38	13.2	15.3	19.4	23.4	32.6	38.7	46.9	58.1	70.4	84.7	100	100	100	100	100	100	100	100	100
SIK40GN-A□ SIK40GN-E□ SIK40GN-C□ SIK40GN-H□ SIK40GN-S□	容许力矩 Allowance Torque	0.63	0.76	1.1	1.3	1.6	1.9	2.6	3.2	3.8	4.7	5.7	6.8	8.6	10	10	10	10	10	10	10	10
		6.42	7.75	11.2	13.2	16.3	19.3	26.5	32.6	38.7	47.9	58.1	69.3	87.7	100	100	100	100	100	100	100	100

### ■ 外形图 (单位 mm) Dimensions (Unit mm)

减速器附有安装用螺丝 Mounting screws are included with gearhead.

- 导线型 Lead Wiring Type (感应/可逆 Induction/Reversible Motor)  
重量 Weight: 电动机 Motor: 2.4kg 减速器 Gearhead: 1.35kg



- 导线型 Lead Wiring Type (刹车 Brake Motors)  
重量 Weight: 电动机 Motor: 3.1kg 减速器 Gearhead: 1.35kg

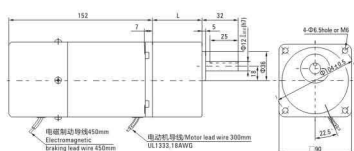

- 导线型 Lead Wiring Type (调速 Speed Control Motors)  
重量 Weight: 电动机 Motor: 2.5kg 减速器 Gearhead: 1.35kg

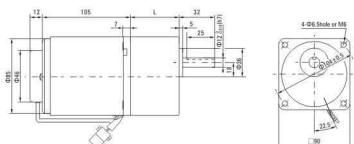

- 圆轴型的转轴部分 Shaft Section Of Round Shaft Type

除重量及轴部外形与电动机相同。  
Excluding weight and the shaft section part shape are the same as those of the pinion shaft type.

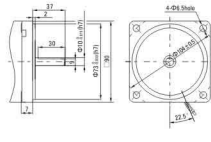

- 中间减速器 Decimal Gearhead

可安装在齿轴齿轮型上 Can be connected to GN pinion shaft type  
电动机外形与齿轴齿轮型相同  
Motor shape is the same as that of the pinion shaft type  
SGN10XX  
重量 Weight: 0.6kg

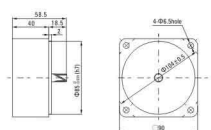

减速器型号 Gearhead Model	减速比 Gear Ratio	L1
SGN□K	3-18	42
	25-200	60

- 减速器型号的□中为减速比的数值  
Enter the gear ratio in the box (□) within the model name

- 带端子型 Terminal Box Type (感应/可逆 Induction/Reversible Motor)

重量 Weight: 电动机 Motor: 2.55kg 减速器 Gearhead: 1.35kg

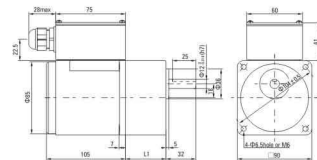

减速器型号 Gearhead Model	减速比 Gear Ratio	L1
SGN□K	3-18	42
	25-200	60

- 减速器型号的□中为减速比的数值  
Enter the gear ratio in the box (□) within the model name

### 弧锥直角

### SPIRAL BEVEL RIGHT ANGLE

### 容许力矩单位 Allowance Torque Unit: 上段 Upside (N.m) / 下段 Belowside (kgf.cm)

机型 Type 电动机/弧锥直角 Motor/Gearhead	减速比 Gear Ratio	容许力矩 Allowance Torque																			
		3	3.6	5	6	7.5	9	12.5	15	18	25	30	36	50	60	75	90	100	120	150	180
SIK40GU-A□ SIK40GU-E□ SIK40GU-C□ SIK40GU-H□ SIK40GU-S□	50Hz	500	417	300	250	200	166	120	100	83	60	50	42	30	25	20	16	15	12	10	8
		600	500	360	300	240	200	144	120	100	72	60	50	36	30	24	20	18	15	12	10
SIK40GU-A□ SIK40GU-E□ SIK40GU-C□ SIK40GU-H□ SIK40GU-S□	容许力矩 Allowance Torque	0.57	0.68	0.59	1.14	1.58	1.89	2.63	3.16	3.79	5.26	6.31	6.8	9.5	11.4	14.2	17.0	18.9	20.0	20.0	20.0
		5.80	6.96	9.66	11.6	16.1	19.3	26.8	32.2	38.6	53.7	64.4	70	97	116	145	174	193	200	200	200
SIK40GU-A□ SIK40GU-E□ SIK40GU-C□ SIK40GU-H□ SIK40GU-S□	60Hz	0.46	0.55	0.76	0.92	1.27	1.53	2.12	2.55	3.05	4.24	5.09	5.50	7.64	9.16	11.5	13.7	15.3	18.3	20.0	20.0
		4.67	5.61	7.79	9.35	13.0	15.6	21.6	26.0	31.2	43.3	51.9	56.1	77.9	93.5	117	140	156	187	200	200

- 感应尺寸图 Induction Type Drawing

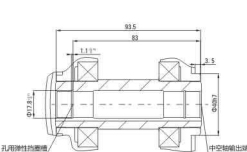
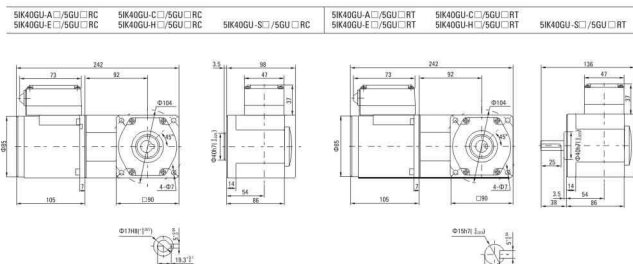



# 60W

交流减速电机 □90mm  
AC GEAR MOTOR

### 感应电动机参数 INDUCTION MOTOR SPECS

型号Model · 类型 Type	上段-齿轮轴 Upper Pinion Shaft	下段-内啮合轴 Below/Round Shaft	输出功率 Output power	电压 Voltage	频率 Frequency	电流 Current	启动转矩 Starting Torque	额定转矩 Rated Torque	额定转速 Rated Speed	电容器容量 Capacitor
导线型 Lead Wire Type	端子箱型 Terminal Box Type	外形图Dimensions②	W	V	Hz	A	mN.m	mN.m	r/min	μF
5IK60GN-AF (5IK60A-AF)	5IK60GN-AFT (5IK60A-AFT)		60	1pH 100	50	1.00	320	470	1250	20.0
5IK60GN-EF (5IK60A-EF)	5IK60GN-EFT (5IK60A-EFT)		60	1pH 110	60	0.80	300	380	1550	12.0
					60	0.85				
5IK60GN-CF (5IK60A-CF)	5IK60GN-CFT (5IK60A-CFT)		60	1pH 220	50	0.50	340	470	1250	4.0
					60	0.55				
5IK60GN-HF (5IK60A-HF)	5IK60GN-HFT (5IK60A-HFT)		60	1pH 220	60	0.50	340	380	1550	4.0
					60	0.55				
5IK60GN-SF (5IK60A-SF)	5IK60GN-SFT (5IK60A-SFT)		60	3pH 220	50	0.45	1000	470	1250	-
					60	0.40	800	380	1550	-

### 可逆/刹车电动机参数 REVERSIBLE MOTOR SPECS

型号Model · 类型 Type	上段-齿轮轴 Upper Pinion Shaft	下段-内啮合轴 Below/Round Shaft	输出功率 Output power	电压 Voltage	频率 Frequency	电流 Current	启动转矩 Starting Torque	额定转矩 Rated Torque	额定转速 Rated Speed	电容器容量 Capacitor
导线型 Lead Wire Type	端子箱型 Terminal Box Type	外形图Dimensions②	W	V	Hz	A	mN.m	mN.m	r/min	μF
5IK60GN-AF (5IK60A-AF)	5IK60GN-AFT (5IK60A-AFT)		60	1pH 100	50	1.26	470	470	1250	25.0
					60	1.10	380	380	1550	
5IK60GN-EF (5IK60A-EF)	5IK60GN-EFT (5IK60A-EFT)		60	1pH 110	60	1.05	330	380	1550	15.0
					60	1.05	360	380	1550	
5IK60GN-CF (5IK60A-CF)	5IK60GN-CFT (5IK60A-CFT)		60	1pH 220	50	0.55	420	470	1250	4.5
					60	0.60	460	380	1550	
5IK60GN-HF (5IK60A-HF)	5IK60GN-HFT (5IK60A-HFT)		60	1pH 220	60	0.55	420	380	1550	4.5
					60	0.60	460	380	1550	

### 调速电动机参数 SPEED CONTROL MOTOR SPECS

型号Model · 类型 Type	导线型 Lead Wire Type	最大输出功率 Output power	电压 Voltage	频率 Frequency	调速范围 Speed Control Range	容许转矩 Allowance Torque		启动转矩 Starting Torque	电流 Current	电容器容量 Capacitor
						1200r/min mN.m	90r/min mN.m			
5IK60GN-AF	5IK60RA-AF	60	1pH 100	50	90-1350	460	140	265	1.00	20.0
						490	160	1.10		
5IK60GN-EF	5IK60RA-EF	60	1pH 110	60	90-1650	490	160	265	0.80	12.0
						490	160	0.85		
5IK60GN-CF	5IK60RA-CF	60	1pH 220	50	90-1350	490	140	265	0.50	4.0
						490	140	0.55		
5IK60GN-HF	5IK60RA-HF	60	1pH 220	60	90-1650	490	160	265	0.50	4.0
						490	160	0.55		

### 装有减速器时的容许转矩 Gear Motor-Torque Table

- 减速器另售。中间减速器另售。  
Gearhead and mid-gearbox can be sold separately.
- 减速器型号的□中为减速比的数值。  
Enter the gear ratio in the box(□) within the model name.
- □色表示与电动机同一方向旋转，其他则为相反方向。  
The colored background □ indicates the same rotating direction of the motor while the rotating direction of others are opposite.

### 容许力矩单位 Allowance Torque Unit : 上段 Upside ( N.m ) / 下段 Belowside ( kgf.cm )

类型 Type 电动机/减速器 Motor/Gearhead	减速比 Gear Ratio	3	3.6	5	6	7.5	9	12.5	15	18	25	30	36	50	60	75	90	100	120	150	180	200	
		50Hz Speed r/min	500	417	300	250	200	166	120	100	83	60	50	41	30	25	20	16	15	12.5	10	8.3	7.5
5IK60GN-AF□ 5IK60GN-EF□ 5IK60GN-CF□ 5IK60GN-HF□ 5IK60GN-SF□	5GN□K	50Hz	600	500	360	300	240	200	144	120	100	72	60	50	36	30	24	20	18	15	12	10	9
			600	500	360	300	240	200	144	120	100	72	60	50	36	30	24	20	18	15	12	10	9
	50Hz	600	500	360	300	240	200	144	120	100	72	60	50	36	30	24	20	18	15	12	10	10	10
		600	500	360	300	240	200	144	120	100	72	60	50	36	30	24	20	18	15	12	10	10	10
	60Hz	600	500	360	300	240	200	144	120	100	72	60	50	36	30	24	20	18	15	12	10	10	10
		600	500	360	300	240	200	144	120	100	72	60	50	36	30	24	20	18	15	12	10	10	10

### 外形图 (单位 mm) Dimensions(Unit mm)

减速器附有安装用螺丝 Mounting screws are included with gearhead.

#### ● 导线型 Lead Wiring Type (感应/可逆 Induction/Reversible Motor)

重量 Weight : 电动机 Motor : 2.7kg  
减速器 Gearhead : 1.35kg

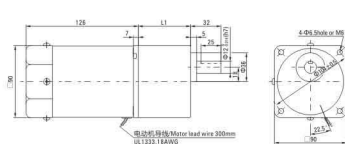

#### ● 导线型 Lead Wiring Type (刹车 Brake Motors)

重量 Weight : 电动机 Motor : 3.5kg  
减速器 Gearhead : 1.35kg

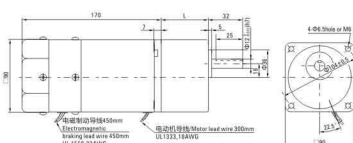

#### ● 导线型 Lead Wiring Type (调速 Speed Control Motors)

重量 Weight : 电动机 Motor : 1.1kg  
减速器 Gearhead : 0.5kg

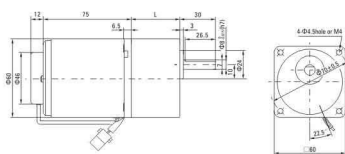

#### ● 轴型的轴部分 Shaft Section Of Round Shaft Type

除重量及轴部分电动机外形与齿轮轴型相同。  
Excluding weight and the shaft section motor shape are the same as those of the pinion shaft type.

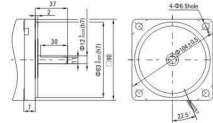

#### ● 中间减速器 Decimal Gearhead

可安装在GN的齿轮轴上 Can be connected to GN pinion shaft type  
电动机外形与齿轮轴型相同  
SGN100X  
重量 Weight : 0.6kg

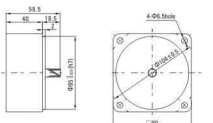

减速器型号 Gearhead Model	减速比 Gear Ratio	L1
5GN□K	3-18	42
	25-200	60

● 减速器型号的□中为减速比的数值  
Enter the gear ratio in the box (□) within the model name





# 60W

交流减速电机 □90mm  
AC GEAR MOTOR

## 感应电动机参数 INDUCTION MOTOR SPECS

型号Model - 类型 Type 上段总轴轴 Upper Pinion Shaft 下段(内)轴轴 Below/Round Shaft		输出功率 Output power W	电压 Voltage V	频率 Frequency Hz	电流 Current A	启动转矩 Starting Torque mN.m	额定转矩 Rated Torque mN.m	额定转速 Rated Speed r/min	电容器容量 Capacitor μF
导线型 Lead Wire Type 外形图Dimensions②	端子箱型 Terminal Box Type 外形图Dimensions②								
SIK60GU-AF	SIK60GU-AFT	60	1ph 100	50	1.00	470	470	1250	20.0
					0.80	380	1550		
SIK60GU-EF	SIK60GU-EFT	60	1ph 110	60	1.10	300	380	1550	12.0
					0.85	300	1550		
SIK60GU-CF	SIK60GU-CFT	60	1ph 220	50	0.50	340	470	1250	4.0
					0.55	340	1250		
					0.50	340	1250		
SIK60GU-HF	SIK60GU-HFT	60	1ph 230	60	0.55	340	380	1550	
					0.55	340	1550		
SIK60GU-SF	SIK60GU-SFT	60	3ph 220	60	0.45	1000	470	1250	
					0.40	800	380	1550	

## 可逆/刹车电动机参数 REVERSIBLE MOTOR SPECS

型号Model - 类型 Type 上段总轴轴 Upper Pinion Shaft 下段(内)轴轴 Below/Round Shaft		输出功率 Output power W	电压 Voltage V	频率 Frequency Hz	电流 Current A	启动转矩 Starting Torque mN.m	额定转矩 Rated Torque mN.m	额定转速 Rated Speed r/min	电容器容量 Capacitor μF
导线型 Lead Wire Type 外形图Dimensions②	端子箱型 Terminal Box Type 外形图Dimensions②								
SIK60GU-AF	SIK60GU-AFT	60	1ph 100	50	1.26	470	470	1250	25.0
					1.70	380	1550		
SIK60GU-EF	SIK60GU-EFT	60	1ph 110	60	1.05	330	380	1550	15.0
					0.85	380	1550		
SIK60GU-CF	SIK60GU-CFT	60	1ph 220	50	0.55	420	470	1250	4.5
					0.60	460	1250		
					0.55	420	1250		
SIK60GU-HF	SIK60GU-HFT	60	1ph 230	60	0.60	460	380	1550	4.5
					0.60	460	1550		

## 调速电动机参数 SPEED CONTROL MOTOR SPECS

型号Model - 类型 Type 导线型 Lead Wire Type	最大 输出功率 Output power W	电压 Voltage V	频率 Frequency Hz	调速范围 Speed Control Range r/min	容许转矩 Allowance Torque		启动转矩 Starting Torque mN.m	电流 Current A	电容器容量 Capacitor μF
					1200r/min mN.m	90r/min mN.m			
5IK60RGU-AF	60	1ph 100	60	50	90-1350	460	140	265	20.0
				60	90-1650	490	160		
5IK60RGU-EF	60	1ph 110	60	90	90-1650	490	160	265	12.0
				120					
5IK60RGU-CF	60	1ph 220	50	90	90-1350	490	140	265	4.0
				120					
				230					
5IK60RGU-HF	60	1ph 230	60	90	90-1650	490	160	265	4.0
				230					

## ■ 装有减速器时的容许转矩 Gear Motor-Torque Table

- 减速器另售 中间减速器另售。  
Gearhead and mid-gearbox can be sold separately.
- 减速器型号的□中为减速比的数值。  
Enter the gear ratio in the box (□) within the model name.

■ 表示与电动机同一方向运转, 其他则为相反方向。  
The colored background ■ indicates the same rotating direction of the motor while the rotating direction of others are opposite.

The colored background □ indicates the same rotating direction of the motor while the rotating direction of others are opposite.

## 容许力矩单位 Allowance Torque Unit : 上段 Upside ( N.m ) / 下段 Belowside ( kgf.cm )

类型 Type 电动机/减速机 Motor/Gearhead	减速比 Gear Ratio	3	3.6	5	6	7.5	9	12.5	15	18	25	30	36	50	60	75	90	100	120	150	180	200
		转速 Speed r/min	50Hz	500	417	300	250	200	166	120	100	83	60	50	41	30	25	20	16	15	12.5	10
SIK90GU-AF□ SIK90GU-EF□ SIK90GU-CF□ SIK90GU-HF□ SIK90GU-SF□	5GU□KB 5GU□K	50Hz	1.1	2.0	2.8	3.4	4.3	5.1	6.4	7.7	9.2	11.6	13.6	16.6	20	24	20	18	15	12	10	9
		60Hz	17.3	20.4	28.6	34.7	43.9	52.0	65.3	78.6	93.3	118	142	169	200	200	200	200	200	200	200	200
		60Hz	1.4	1.7	2.3	2.8	3.5	4.2	5.2	6.2	7.5	9.4	11.3	13.5	18.8	20	20	18.8	20	20	20	20
		60Hz	14.3	17.3	23.5	28.6	35.7	42.9	51.1	63.3	76.5	95.9	115	138	19.2	200	192	200	200	200	200	200

## ■ 外形图 (单位 mm) Dimensions(Unit mm)

减速器时安装有顶螺丝 Mounting screws are included with gearhead.

### ● 导线型 Lead Wiring Type (感应/可逆/刹车电动机)

重量 Weight : 电动机 Motor : 3.2kg 减速器 Gearhead : 1.5kg

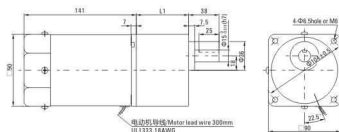

### ● 导线型 Lead Wiring Type (刹车 Brake Motors)

重量 Weight : 电动机 Motor : 3.55kg 减速器 Gearhead : 1.5kg

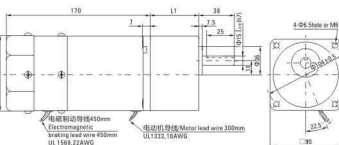

### ● 导线型 Lead Wiring Type (调速 Speed Control Motors)

重量 Weight : 电动机 Motor : 2.8kg 减速器 Gearhead : 1.5kg

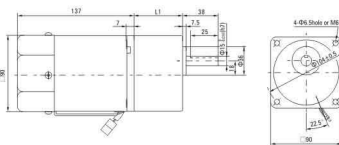

### ● 圆轴系的转轴部分 Shaft Section Of Round Shaft Type

除重量及轴部外形电动机外形与齿轮轴型相同。  
Excluding weight and the shaft section motor shape are the same as those of the pinion shaft type.

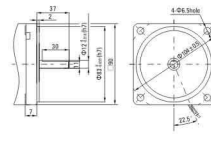

### ● 中间减速器 Decimal Gearhead

可安装在轴轮轴型 L1 can be connected to GU pinion shaft type  
电动机外形与齿轮轴型相同  
5GU100X  
重量 Weight : 0.65kg

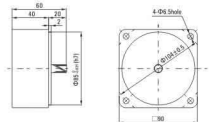

减速器型号 Gearhead Model	减速比 Gear Ratio	L1
5GU□KB	3-200	65.5

### ● 减速器型号的□中为减速比的数值

Enter the gear ratio in the box (□) within the model name

- 带端子箱型 Terminal Box Type (感应可逆Induction/Reversible Motor)  
重量 Weight : 电动机 Motor : 2.85kg 减速机 Gearhead : 1.5kg

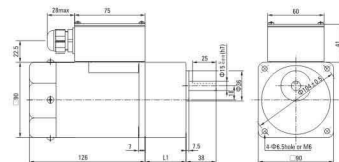

减速机型号 Gearhead Model	减速比 Gear Ratio	L1
5GU□KB	3~200	65.5

●减速机型号的□中为减速比的数值  
Enter the gear ratio in the box (□) within the model name

### 弧锥直角 SPIRAL BEVEL RIGHT ANGLE

容许力矩单位 Allowance Torque Unit: 上段 Upside (N.m) / 下段 Belowside (kgf.cm)

机型Type 电动机/减速机 Motor/Gearhead	齿数比Gear Ratio	3	3.6	5	6	7.5	9	12.5	15	18	25	30	36	50	60	75	90	100	120	150	180
5K90GU-AF□ 5K90GU-EF□ 5K90GU-CF□ 5K90GU-HF□ 5K90GU-SF□	50Hz 转速Speed r/min	500	417	300	250	200	166	120	100	83	60	50	42	30	25	20	16	15	12	10	8
	60Hz	600	500	360	300	240	200	144	120	100	72	60	50	36	30	24	20	18	15	12	10
容许力矩 Allowance Torque	50Hz	0.85	1.02	1.42	1.70	2.37	2.84	3.95	4.73	5.68	7.89	9.47	10.2	14.2	17.0	20.0	20.0	20.0	20.0	20.0	20.0
	60Hz	8.70	10.4	14.5	17.4	24.2	29.0	40.3	48.3	58.0	80.5	96.6	104	145	174	200	200	200	200	200	200
容许力矩 Allowance Torque	50Hz	0.69	0.82	1.15	1.37	1.91	2.29	3.18	3.82	4.58	6.36	7.64	8.25	11.5	13.7	17.2	20.0	20.0	20.0	20.0	20.0
	60Hz	6.73	8.08	11.2	13.5	19.48	23.37	32.46	38.96	46.75	64.93	77.92	84.1	117	140	175	200	200	200	200	200

### ■ 感应尺寸图 Induction Type Drawing

5K90GU-AF□/5GU□RC 5K90GU-EF□/5GU□RC	5K90GU-CF□/5GU□RC 5K90GU-HF□/5GU□RC	5K90GU-SF□/5GU□RC	5K90GU-AF□/5GU□RT 5K90GU-EF□/5GU□RT	5K90GU-CF□/5GU□RT 5K90GU-HF□/5GU□RT	5K90GU-SF□/5GU□RT
--	--	-------------------	--	--	-------------------

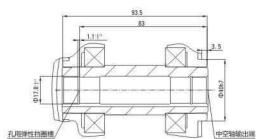
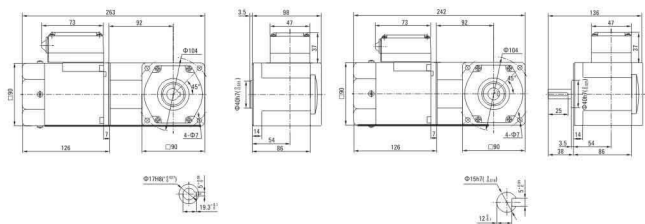

# 90W

交流减速电机 □90mm  
AC GEAR MOTOR

### ■ 感应电动机参数 INDUCTION MOTOR SPECS

型号Model · 类型 Type 上段:齿轴轴 Upper/Pinion Shaft 下段(内):里轴 Below/Round Shaft	输出功率 Output power W	电压 Voltage V	频率 Frequency Hz	电流 Current A	启动转矩 Starting Torque mN.m	额定转矩 Rated Torque mN.m	额定转速 Rated Speed r/min	电容器容量 Capacitor μF
导线型 Lead Wire Type 外形尺寸Dimensions①	90	1ph 100	50	1.55	450	700	1250	25.0
带端子箱型 Terminal Box Type 外形尺寸Dimensions②			60	1.85		570	1550	
5K90GU-AF (5K90A-AF)	90	1ph 110	60	1.40	500	570	1550	20.0
			5K90GU-EF (5K90A-EF)	60		1.45	570	
5K90GU-CF (5K90A-CF)	90	1ph 220	50	0.72	450	700	1250	5.0
			5K90GU-CFT (5K90A-CFT)	60		0.70	570	
5K90GU-HF (5K90A-HF)	90	1ph 220	60	0.71	450	570	1550	5.0
			5K90GU-HFT (5K90A-HFT)	60		0.75	570	
5K90GU-SF (5K90A-SF)	90	3ph 220	50	0.60	1350	700	1250	-
			5K90GU-SFT (5K90A-SFT)	60		0.55	1100	

### ■ 可逆/刹车电动机参数 REVERSIBLE MOTOR SPECS

型号Model · 类型 Type 上段:齿轴轴 Upper/Pinion Shaft 下段(内):里轴 Below/Round Shaft	输出功率 Output power W	电压 Voltage V	频率 Frequency Hz	电流 Current A	启动转矩 Starting Torque mN.m	额定转矩 Rated Torque mN.m	额定转速 Rated Speed r/min	电容器容量 Capacitor μF
导线型 Lead Wire Type 外形尺寸Dimensions①	90	1ph 100	50	1.78	600	700	1250	30.0
带端子箱型 Terminal Box Type 外形尺寸Dimensions②			60	2.35		570	1550	
5K90GU-AF (5K90A-AF)	90	1ph 110	60	1.72	550	570	1550	25.0
			5K90GU-EF (5K90A-EF)	60		1.72	600	
5K90GU-CF (5K90A-CF)	90	1ph 220	50	0.82	560	700	1250	6.0
			5K90GU-CFT (5K90A-CFT)	60		0.81	570	
5K90GU-HF (5K90A-HF)	90	1ph 220	60	0.81	560	560	1550	6.0
			5K90GU-HFT (5K90A-HFT)	60		0.80	570	

### ■ 调速电动机参数 SPEED CONTROL MOTOR SPECS

型号Model · 类型 Type 导线型 Lead Wire Type	最大 输出功率 Output power W	电压 Voltage V	频率 Frequency Hz	调速范围 Speed Control Range r/min	容许转矩 Allowance Torque 1200/r/min 90/r/min mN.m	启动转矩 Starting Torque mN.m	电流 Current A	电容器容量 Capacitor μF
齿轴轴型 Pinion Shaft	90	1ph 100	50	90-1350	710	405	1.55	25.0
				90-1650		230	1.85	
圆轴型 Round Shaft	90	1ph 110	60	90-1650	710	260	1.40	20.0
				90-1650		260	1.45	
5K90GU-AF	90	1ph 220	50	90-1350	710	410	0.72	5.0
				90-1650		230	0.70	
5K90GU-EF	90	1ph 220	60	90-1650	710	410	0.71	5.0
				90-1650		260	0.75	

### ■ 装有减速器时的容许转矩 Gear Motor-Torque Table

- 减速器另售: 中间减速器另售。  
Gearhead and mid-gearhead can be sold separately.
- 减速器型号的□中为减速比的数值。  
Enter the gear ratio in the box (□) within the model name.

- 颜色表示与电动机同一方向运转, 其他则为相反方向。  
The colored background □ indicates the same rotating direction of the motor while the rotating direction of others are opposite.

### 容许力矩单位 Allowance Torque Unit: 上段 Upside (N.m) / 下段 Belowside (kgf.cm)

类型 Type 电动机/减速器 Motor/Gearhead	减速比 Gear Ratio	容许力矩 Allowance Torque Unit																						
		3	3.6	5	6	7.5	9	12.5	15	18	25	30	36	50	60	75	90	100	120	150	180	200		
5K190GU-AF□ 5K190GU-EF□ 5K190GU-CF□ 5K190GU-HF□ 5K190GU-SF□	5GU□KB	50Hz	500	417	300	250	200	166	120	100	83	60	50	41	30	25	20	16	15	12.5	10	8.3	7.5	
		60Hz	600	500	360	300	240	200	144	120	100	72	60	50	36	30	24	20	18	15	12	10	9	
5K190GU-AF□ 5K190GU-EF□ 5K190GU-CF□ 5K190GU-HF□ 5K190GU-SF□	5GU□K	50Hz	1.1	2.0	2.8	3.4	4.3	5.1	6.4	7.7	9.2	11.6	13.6	16.6	20	20	20	20	20	18	15	12	10	9
		60Hz	1.4	1.7	2.3	2.8	3.5	4.2	5.2	6.2	7.5	9.4	11.3	13.5	18.8	20	20	20	20	20	18.8	20	20	20

### ■ 外形图 (单位 mm) Dimensions(Unit mm)

减速器附有安装用螺丝 Mounting screws are included with gearhead.

#### ● 导线型 Lead Wiring Type (感应/可逆 Induction/Reversible Motor)

重量 Weight: 电动机 Motor: 3.2kg 减速器 Gearhead: 1.5kg

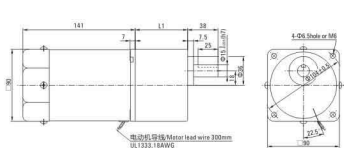

#### ● 导线型 Lead Wiring Type (刹车 Brake Motors)

重量 Weight: 电动机 Motor: 4.3kg 减速器 Gearhead: 1.5kg

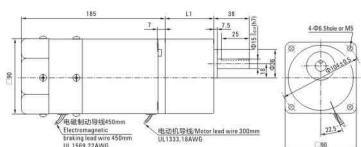

#### ● 导线型 Lead Wiring Type (调速 Speed Control Motors)

重量 Weight: 电动机 Motor: 3.3kg 减速器 Gearhead: 1.5kg

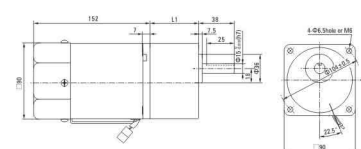

#### ● 圆锥轴的转轴部分 Shaft Section Of Round Shaft Type

除重量及轴部分电动机外形与齿轮轴型相同。  
Excluding weight and the shaft section motor shape are the same as those of the pinion shaft type.

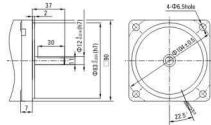

#### ● 中间减速器 Decimal Gearhead

可安装在GU齿轴型上 Can be connected to GU pinion shaft type  
电动机外形与齿轮轴型相同  
SGU10X

重量 Weight: 0.85kg

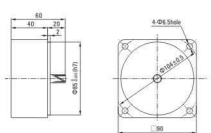

减速器型号 Gearhead Model	减速比 Gear Ratio	L1
5GU□KB	3~200	65.5

- 减速器型号的□中为减速比的数值  
Enter the gear ratio in the box (□) within the model name

#### ● 带端子箱型 Terminal Box Type (感应/可逆 Induction/Reversible Motor)

重量 Weight: 电动机 Motor: 3.35kg 减速器 Gearhead: 1.5kg

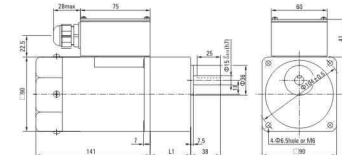

减速器型号 Gearhead Model	减速比 Gear Ratio	L1
5GU□KB	3~200	65.5

- 减速器型号的□中为减速比的数值  
Enter the gear ratio in the box (□) within the model name

### 圆锥直角

### SPIRAL BEVEL RIGHT ANGLE

### 容许力矩单位 Allowance Torque Unit: 上段 Upside (N.m) / 下段 Belowside (kgf.cm)

机型 Type 电动机/减速器 Motor/Gearhead	减速比 Gear Ratio	容许力矩 Allowance Torque																					
		3	3.6	5	6	7.5	9	12.5	15	18	25	30	36	50	60	75	90	100	120	150	180		
5K190GU-AF□ 5K190GU-EF□ 5K190GU-CF□ 5K190GU-HF□ 5K190GU-SF□	5GU□RC	50Hz	500	417	300	250	200	166	120	100	83	60	50	42	30	25	20	16	15	12	10	8	8
		60Hz	600	500	360	300	240	200	144	120	100	72	60	50	36	30	24	20	18	15	12	10	9
5K190GU-AF□ 5K190GU-EF□ 5K190GU-CF□ 5K190GU-HF□ 5K190GU-SF□	5GU□RT	50Hz	1.28	1.53	2.13	2.56	3.55	4.26	5.92	7.10	8.52	11.8	14.2	15.3	20.0	20.0	20.0	20.0	20.0	20.0	20.0	20.0	20.0
		60Hz	1.30	15.7	21.7	26.1	36.2	43.5	60.4	72.5	87.0	121	145	157	200	200	200	200	200	200	200	200	200
5K190GU-AF□ 5K190GU-EF□ 5K190GU-CF□ 5K190GU-HF□ 5K190GU-SF□	5GU□RC	50Hz	1.03	1.24	1.72	2.06	2.86	3.44	4.77	5.73	6.87	9.54	11.5	12.4	17.2	20.0	20.0	20.0	20.0	20.0	20.0	20.0	20.0
		60Hz	10.5	12.6	17.5	21.0	29.2	35.1	48.7	58.4	70.1	97.4	117	126	175	200	200	200	200	200	200	200	200

#### ■ 感应尺寸图 Induction Type Drawing

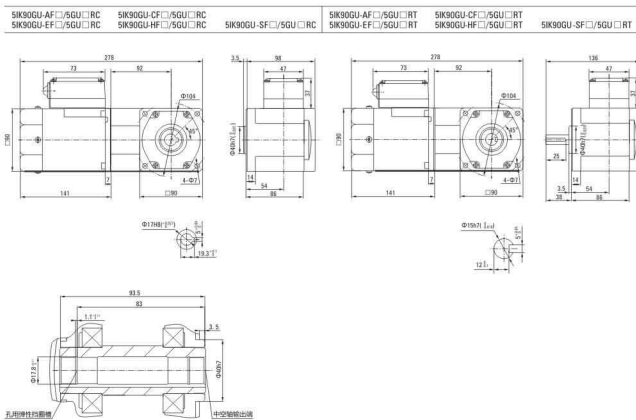



# 120W

交流调速电机 □90mm  
AC GEAR MOTOR

## ■ 感应电动机参数 INDUCTION MOTOR SPECS

型号Model / 类型 Type 上段 齿轮轴 Upper Pinion Shaft 下段(内)型轴 Below/Round Shaft		输出功率 Output power W	电压 Voltage V	频率 Frequency Hz	电流 Current A	启动转矩 Starting Torque mN.m	额定转矩 Rated Torque mN.m	额定转速 Rated Speed r/min	电容器容量 Capacitor μF
导线型 Lead Wire Type 外形图Dimensions①	带端子箱型 Terminal Box Type 外形图Dimensions②								
5K120GU-AF (5K120A-AF)	5K120GU-AFT (5K120A-AFT)	120	1ph 100	50	2.1	600	930	1250	30.0
					2.5		750		
5K120GU-EF (5K120A-EF)	5K120GU-EFT (5K120A-EFT)	120	1ph 110	60	1.65	600	750	1550	25.0
					1.80		1550		
5K120GU-CF (5K120A-CF)	5K120GU-CFT (5K120A-CFT)	120	1ph 220	50	1.0	650	930	1250	7.0
					0.95		1250		
5K120GU-HF (5K120A-HF)	5K120GU-HFT (5K120A-HFT)	120	1ph 230	60	1.0	600	750	1550	7.0
					0.95		1550		
5K120GU-SF (5K120A-SF)	5K120GU-SFT (5K120A-SFT)	120	3ph 220	50	0.70	1850	930	1250	-
					0.60		1600		

## ■ 可逆/刹车电动机参数 REVERSIBLE MOTOR SPECS

型号Model / 类型 Type 上段 齿轮轴 Upper Pinion Shaft 下段(内)型轴 Below/Round Shaft		输出功率 Output power W	电压 Voltage V	频率 Frequency Hz	电流 Current A	启动转矩 Starting Torque mN.m	额定转矩 Rated Torque mN.m	额定转速 Rated Speed r/min	电容器容量 Capacitor μF
导线型 Lead Wire Type 外形图Dimensions①	带端子箱型 Terminal Box Type 外形图Dimensions②								
5KR120GU-AF (5KR120A-AF)	5KR120GU-AFT (5KR120A-AFT)	120	1ph 100	50	2.25	700	930	1250	35.0
					2.85		750		
5KR120GU-EF (5KR120A-EF)	5KR120GU-EFT (5KR120A-EFT)	120	1ph 110	60	1.90	650	750	1550	30.0
					1.70		720		
5KR120GU-CF (5KR120A-CF)	5KR120GU-CFT (5KR120A-CFT)	120	1ph 220	50	1.15	720	930	1250	8.0
					1.00		1250		
5KR120GU-HF (5KR120A-HF)	5KR120GU-HFT (5KR120A-HFT)	120	1ph 230	60	1.20	720	750	1550	8.0
					1.10		1550		

## ■ 调速电动机参数 SPEED CONTROL MOTOR SPECS

型号Model / 类型 Type 导线型 Lead Wire Type		最大输出功率 Output power W	电压 Voltage V	频率 Frequency Hz	调速范围 Speed Control Range r/min	容许转矩 Allowance Torque		启动转矩 Starting Torque mN.m	电流 Current A	电容器容量 Capacitor μF
齿轮轴型 Pinion Shaft	圆轴型 Round Shaft					1200/mN	90/mN			
5K120RGU-AF	5K120RA-AF	120	1ph 100	50	90-1350	750	330	530	2.10	30
									2.50	
5K120RGU-EF	5K120RA-EF	120	1ph 110	60	90-1650	750	360	530	1.65	25
									1.80	
5K120RGU-CF	5K120RA-CF	120	1ph 220	50	90-1350	750	330	530	1.00	7.0
									0.95	
5K120RGU-HF	5K120RA-HF	120	1ph 230	60	90-1650	750	360	530	1.00	7.0
									0.95	

## ■ 装有减速器时的容许转矩 Gear Motor-Torque Table

- 减速器另售。中间减速器另售。  
Gearhead and mid-gearbox can be sold separately.

Enter the gear ratio in the box (□) within the model name.

- 减速器型号中的□为减速比的数值。

Enter the gear ratio in the box (□) within the model name.

- 色表示与电动机同一方向运转，其他则为相反方向。

The colored background □ indicates the same rotating direction of the motor while the rotating direction of others is opposite.

## 容许力矩单位 Allowance Torque Unit : 上段 Upside ( N.m ) / 下段 Belowside ( kgf.cm )

类型 Type 电动机/减速器 Motor/Gearhead	减速比 Gear Ratio	容许力矩 Allowance Torque Unit																				
		3	3.6	5	6	7.5	9	12.5	15	18	25	30	36	50	60	75	90	100	120	150	180	200
5K120GU-AF□ 5K120GU-EF□ 5K120GU-CF□ 5K120GU-HF□ 5K120GU-SF□	50Hz	500	417	300	250	200	166	120	100	83	60	50	41	30	25	16	15	12.5	10	8.3	7.5	
	转速 Speed r/min	600	500	360	300	240	200	144	120	100	72	60	50	36	30	24	20	18	15	12	10	9
5G□□KB 5G□□K	50Hz	2.3	2.7	3.8	4.5	5.6	6.8	8.5	10.2	12.2	15.3	18.4	20	20	20	20	20	20	20	20	20	20
	60Hz	1.8	2.2	3.0	3.6	4.6	5.5	6.8	8.2	9.8	12.4	14.9	17.8	20	20	20	20	20	20	20	20	20
5G□□KB 5G□□K	50Hz	23.4	27.5	38.7	45.9	57.1	69.3	86.7	104	124	156	187	200	200	200	200	200	200	200	200	200	200
	60Hz	18.3	22.4	30.6	36.7	46.9	56.1	69.5	83.6	100	126	152	181	200	200	200	200	200	200	200	200	200

## ■ 外形图 (单位 mm) Dimensions(Unit mm)

减速器附有安装用螺丝。Mountings screws are included with gearhead.

### ● 导线型 Lead Wiring Type (感应/可逆/刹车电动机)

重量 Weight : 电动机 Motor : 3.4kg 减速器 Gearhead : 1.5kg

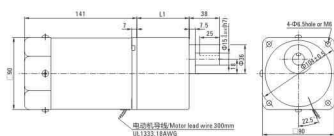

### ● 导线型 Lead Wiring Type (刹车 Brake Motors)

重量 Weight : 电动机 Motor : 4.3kg 减速器 Gearhead : 1.5kg

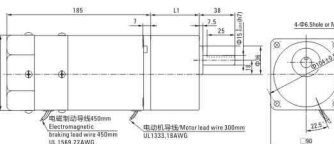

### ● 导线型 Lead Wiring Type (调速 Speed Control Motors)

重量 Weight : 电动机 Motor : 3.5kg 减速器 Gearhead : 1.5kg

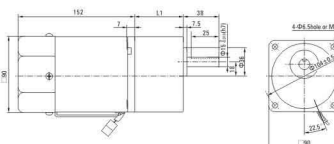

### ● 圆轴型的轴部分 Shaft Section Of Round Shaft Type

除重量及轴部外形与电动机外形相同。

Excluding weight and the shaft section motor shape are the same as those of the pinion shaft type.

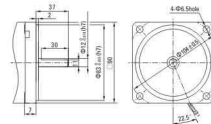

### ● 中间减速器 Decimal Gearhead

可安装在GU齿轮轴型上。Can be connected to GU pinion shaft type

电动机外形与齿轮轴型相同

5G□100K

重量 Weight : 0.6kg

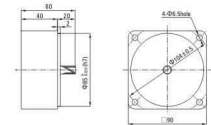

### ● 减速器型号的□为减速比的数值

Enter the gear ratio in the box (□) within the model name

减速器型号 Gearhead Model	减速比 Gear Ratio	L1
5G□□KB	3-200	65.5

● 端子箱型 Terminal Box Type (感应可逆Induction/Reversible Motor)  
重量 Weight: 电动机 Motor: 3.55kg 减速器 Gearhead: 1.5kg

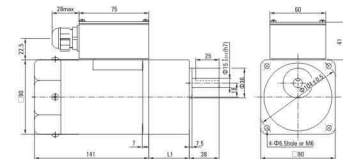

减速器型号 Gearhead Model	减速比 Gear Ratio	L1
5GU□KB	3-200	65.5

● 减速器型号的□中为减速比的数值  
Enter the gear ratio in the box (□) within the model name

弧锥直角  
SPIRAL BEVEL RIGHT ANGLE

容许力矩单位 Allowance Torque Unit: 上段 Upside (N.m) / 下段 Belowside (kgf.cm)

机壳Type 电动机/减速器 Motor/Gearhead	减速比Gear Ratio	转速Speed/r/min																				
		3	3.6	5	6	7.5	9	12.5	15	18	25	30	36	50	60	75	90	100	120	150	180	
5K120GU-AF□ 5K120GU-EF□ 5K120GU-CF□ 5K120GU-HF□ 5K120GU-SF□	容许力矩 Allowance Torque	50Hz	500	417	300	250	200	166	120	100	83	60	50	42	30	25	20	16	15	12	10	8
		60Hz	600	500	360	300	240	200	144	120	100	72	60	50	36	30	24	20	18	15	12	10
5K120GU-AF□ 5K120GU-EF□ 5K120GU-CF□ 5K120GU-HF□ 5K120GU-SF□	容许力矩 Allowance Torque	50Hz	1.70	2.05	2.84	3.41	4.73	5.68	7.89	9.47	11.4	15.8	18.9	20.0	20.0	20.0	20.0	20.0	20.0	20.0	20.0	20.0
		60Hz	17.4	20.9	29.0	34.8	48.3	58.0	80.5	96.6	116	161	193	200	200	200	200	200	200	200	200	200
5K120GU-AF□/5GU□RC 5K120GU-EF□/5GU□RC 5K120GU-CF□/5GU□RC 5K120GU-HF□/5GU□RC 5K120GU-SF□/5GU□RC	容许力矩 Allowance Torque	50Hz	1.37	1.65	2.29	2.75	3.82	4.58	6.36	7.64	9.16	12.7	15.3	16.5	20.0	20.0	20.0	20.0	20.0	20.0	20.0	20.0
		60Hz	14.0	16.8	23.4	28.0	39.0	46.7	64.9	77.9	93.5	130	156	168	200	200	200	200	200	200	200	200

■ 感应尺寸图 Induction Type Drawing

5K120GU-AF□/5GU□RC 5K120GU-EF□/5GU□RC 5K120GU-CF□/5GU□RC 5K120GU-HF□/5GU□RC 5K120GU-SF□/5GU□RC  
5K120GU-AF□/5GU□RT 5K120GU-EF□/5GU□RT 5K120GU-CF□/5GU□RT 5K120GU-HF□/5GU□RT 5K120GU-SF□/5GU□RT

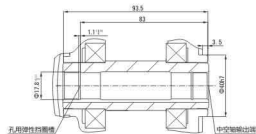
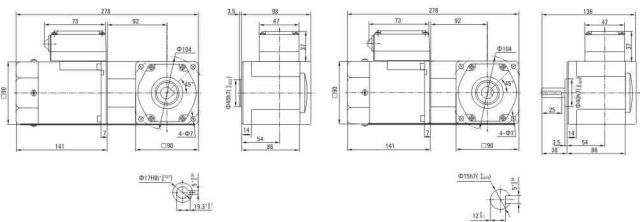

# 120W

交流减速电机 □104mm  
AC GEAR MOTOR

■ 感应电动机参数 INDUCTION MOTOR SPECS

型号Model - 类型 Type 上段齿轴轮 Upper Pinion Shaft 下段内齿轴 Below Round Shaft	输出功率 Output power W	电压 Voltage V	频率 Frequency Hz	电流 Current A	启动转矩 Starting Torque mN.m	额定转矩 Rated Torque mN.m	额定转速 Rated Speed r/min	电容器容量 Capacitor μF
6K120GU-AF (6K120A-AF)	120	1ph 100	50	2.10	600	930	1250	30.0
			60	2.50				
6K120GU-EF (6K120A-EF)	120	1ph 110	50	1.70	600	750	1550	20.0
			60	1.80				
6K120GU-CF (6K120A-CF)	120	1ph 220	50	0.95	750	930	1250	8.0
			60	1.00				
6K120GU-HF (6K120A-HF)	120	1ph 230	50	0.75	2200	890	1300	-
			60	0.70				
6K120GU-SF (6K120A-SF)	120	3ph 220	50	0.75	2200	890	1300	-
			60	0.70				

■ 可逆/刹车电动机参数 REVERSIBLE MOTOR SPECS

型号Model - 类型 Type 导线型 Lead Wire Type	额定 Rating	输出功率 Output power W	电压 Voltage V	频率 Frequency Hz	电流 Current A	启动转矩 Starting Torque mN.m	额定转矩 Rated Torque mN.m	额定转速 Rated Speed r/min	电容器容量 Capacitor μF
6R120GU-AFM 6R120A-AFM	30min	120	1ph 100	50	2.1	600	930	1250	35
				60	2.5				
6R120GU-EFM 6R120A-EFM	30min	120	1ph 110	50	1.70	600	750	1550	30
				60	1.80				
6R120GU-CFM 6R120A-CFM	30min	120	1ph 220	50	0.95	750	930	1250	8.0
				60	0.95				
6R120GU-HFM 6R120A-HFM	30min	120	1ph 230	50	1.0	2200	890	1250	-
				60	0.75				
6R120GU-SFM 6R120A-SFM	30min	120	3ph 220	50	0.75	2200	890	1250	-
				60	0.70				

■ 调速电动机参数 SPEED CONTROL MOTOR SPECS

型号Model - 类型 Type 导线型 Lead Wire Type	最大 输出 功率 Output power W	电压 Voltage V	频率 Frequency Hz	调速范围 Speed Control Range r/min	容许转矩 Allowance Torque		启动转矩 Starting Torque mN.m	电流 Current A	电容器容量 Capacitor μF
					1200r/min mN.m	90r/min mN.m			
6K120RGU-AF 6K120RA-AF	120	1ph 100	50	90-1350	750	360	530	2.10	30
			60	90-1650					
6K120RGU-EF 6K120RA-EF	120	1ph 110 1ph 120	50	90-1350	750	360	520	1.70	20
			60	90-1650					
6K120RGU-CF 6K120RA-CF	120	1ph 220 1ph 230	50	90-1350	750	330	530	0.95	8.0
			60	90-1650					
6K120RGU-HF 6K120RA-HF	120	1ph 220 1ph 230	50	90-1350	750	360	530	0.95	8.0
			60	90-1650					

## ■ 装有减速器时的容许转矩 Gear Motor-Torque Table

- 减速器另售 中间减速器另售。

Gearhead and mid-gearbox can be sold separately.

- 减速品型号的□中为减速比的数值。

Enter the gear ratio in the box (□) within the model name.

- □色表示与电动机同一方向运转，其他则为相反方向。

The colored background □ indicates the same rotating direction of the motor while the rotating direction of others are opposite.

## 容许力矩单位 Allowance Torque Unit : 上段 Upside ( N.m ) / 下段 Belowside ( kgf.cm )

类型 Type 电动机/减速机 Motor/Gearhead	减速比 Gear Ratio	容许力矩 Allowance Torque																					
		3	3.6	5	6	7.5	9	12.5	15	18	25	30	36	50	60	75	90	100	120	150	180	200	
6K120GU-AF□ 6K120GU-EF□ 6K120GU-SF□	6GU□K	50Hz	500	417	300	250	200	166	120	100	83	60	50	41	30	25	20	16	15	12.5	10	8.3	7.5
		转速 Speed/r/min	2.3	2.7	3.8	4.5	5.6	6.8	8.5	10.2	12.2	15.3	18.4	22.1	30.7	36.8	40	40	40	40	40	40	40
6K120GU-AF□ 6K120GU-EF□ 6K120GU-SF□	6GU□K	50Hz	23.4	27.5	38.7	45.9	57.1	69.3	86.7	104	124	156	187	225	313	375	400	400	400	400	400	400	400
		转速 Speed/r/min	2.22	2.6	3.8	4.3	5.4	6.5	8.1	9.7	11.7	14.7	17.6	21.1	29.4	35.2	40	40	40	40	40	40	40
6K120GU-AF□ 6K120GU-EF□ 6K120GU-SF□	6GU□K	50Hz	2.4	28.5	36.7	43.8	55.0	66.3	87.6	98.8	119	149	179	215	300	359	400	400	400	400	400	400	400
		转速 Speed/r/min	2.3	2.7	3.8	4.5	5.6	6.8	8.5	10.2	12.2	15.3	18.4	22.1	30.7	36.8	40	40	40	40	40	40	40

## ■ 外形图 (单位 mm) Dimensions(Unit mm)

- 减速器附有安装用螺丝/ Mounting screws are included with gearhead.

### ● 导线型 Lead Wiring Type (感应/可逆 Induction/Reversible Motor)

重量 Weight : 电动机 Motor : 4.9kg 减速器 Gearhead : 2.1kg

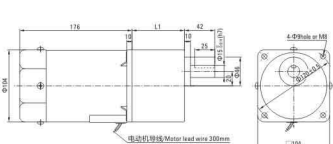

### ● 导线型 Lead Wiring Type (刹车 Brake Motors)

重量 Weight : 电动机 Motor : 5.65kg 减速器 Gearhead : 2.1kg

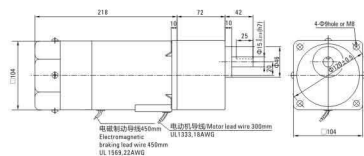

### ● 导线型 Lead Wiring Type (调速 Speed Control Motors)

重量 Weight : 电动机 Motor : 4.9kg 减速器 Gearhead : 2.1kg

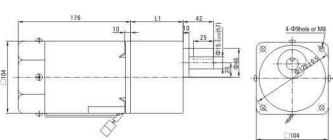

### ● 圆轴型的转轴部分 Shaft Section Of Round Shaft Type

除重量及轴部分电动机外形与齿轮轴相同。

Excluding weight and the shaft section motor shape are the same as those of the pinion shaft type.

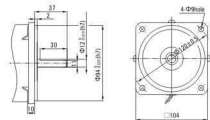

### ● 中间减速器 Decimal Gearhead

可安装在GU齿轮轴型上 Can be connected to GU pinion shaft type

电动机外形与齿轮轴轴型相同

5GU100K

重量 Weight : 0.65kg

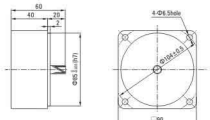

减速器型号 Gearhead Model	减速比 Gear Ratio	L1
6GU□K	3~200	72

- 减速器型号的□中为减速比的数值

Enter the gear ratio in the box (□) within the model name

## ● 带端子箱型 Terminal Box Type (感应/可逆 Induction/Reversible Motor)

重量 Weight : 电动机 Motor : 4.95kg 减速器 Gearhead : 2.1kg

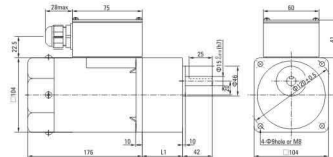

减速器型号 Gearhead Model	减速比 Gear Ratio	L1
6GU□K	3~200	72

- 减速器型号的□中为减速比的数值

Enter the gear ratio in the box (□) within the model name

## 圆锥直角

## SPIRAL BEVEL RIGHT ANGLE

## 容许力矩单位 Allowance Torque Unit: 上段 Upside (N.m) / 下段 Belowside (kgf.cm)

机型 Type 电动机/减速器 Motor/Gearhead	减速比 Gear Ratio	容许力矩 Allowance Torque																				
		3	3.6	5	6	7.5	9	12.5	15	18	25	30	36	50	60	75	90	100	120	150	180	
6K120GU-AF□ 6K120GU-EF□ 6K120GU-CF□ 6K120GU-HF□ 6K120GU-SF□	6GU□RT	50Hz	1.70	2.05	2.84	3.41	4.26	5.68	7.89	9.47	11.4	15.8	18.9	22.7	28.4	34.1	42.6	51.1	56.8	60.0	60.0	60.0
		转速 n/r/min	600	500	360	300	240	200	144	120	100	72	60	50	36	30	24	20	18	15	12	10
6K120GU-AF□ 6K120GU-EF□ 6K120GU-CF□ 6K120GU-HF□ 6K120GU-SF□	6GU□RT	50Hz	17.4	20.9	29.0	34.8	43.5	58.0	80.5	96.6	116	161	193	232	290	348	435	522	580	600	600	600
		转速 n/r/min	1.37	1.65	2.29	2.75	3.44	4.59	6.36	7.64	9.16	12.7	15.3	18.3	22.9	27.5	34.4	41.2	45.8	55.0	60.0	60.0
6K120GU-AF□ 6K120GU-EF□ 6K120GU-CF□ 6K120GU-HF□ 6K120GU-SF□	6GU□RT	50Hz	14.0	16.8	23.4	28.0	35.1	46.7	64.9	77.9	93.5	130	156	187	234	280	351	421	467	561	600	600
		转速 n/r/min	1.37	1.65	2.29	2.75	3.44	4.59	6.36	7.64	9.16	12.7	15.3	18.3	22.9	27.5	34.4	41.2	45.8	55.0	60.0	60.0

## ■ 感应尺寸图 Induction Type Drawing

6K120GU-AF□/6GU□RT	6K120GU-CF□/6GU□RT	6K120GU-SF□/6GU□RT	6K120GU-AF□/6GU□RT	6K120GU-CF□/6GU□RT	6K120GU-HF□/6GU□RT	5K120GU-SF□/6GU□RT
--------------------	--------------------	--------------------	--------------------	--------------------	--------------------	--------------------

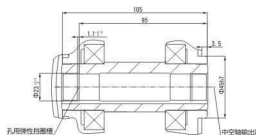
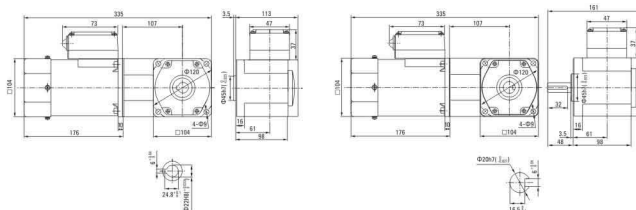



# 140W

交流减速电机 □ 104mm  
AC GEAR MOTOR

## ■ 感应电动机参数 INDUCTION MOTOR SPECS

型号Model、类型 Type 上段上轴轮 Upper/Pinion Shaft 下段内轴轮 Below/Round Shaft		输出功率 Output power W	电压 Voltage V	频率 Frequency Hz	电流 Current A	启动转矩 Starting Torque mNm	额定转矩 Rated Torque mNm	额定转速 Rated Speed r/min	电容器容量 Capacitor μF
导线型 Lead Wire Type 外形尺寸Dimensions①	端子箱型 Terminal Box Type 外形尺寸Dimensions②								
6K140GU-AF (6K140A-AF)	6K140GU-AFT (6K140A-AFT)	140	1ph 100	50	2.7	700	1080	1250	35.0
					3.0		870	1550	
6K140GU-EF (6K140A-EF)	6K140GU-EFT (6K140A-EFT)	140	1ph 110	60	1.80	700	850	1600	25.0
					1.95				
6K140GU-CF (6K140A-CF)	6K140GU-CFT (6K140A-CFT)	140	1ph 220	50	1.05	850	1040	1350	10.0
					1.15				
6K140GU-HF (6K140A-HF)	6K140GU-HFT (6K140A-HFT)	140	1ph 230	60	1.05	750	850	1600	-
					1.15				
6K140GU-SF (6K140A-SF)	6K140GU-SFT (6K140A-SFT)	140	3ph 220	50	0.85	2700	1080	1250	-
					0.75		2200	1550	

## ■ 可逆/刹车电动机参数 REVERSIBLE MOTOR SPECS

齿轮轴型 Pinion Shaft	圆轴型 Round Shaft	额定 Rating	输出功率 Output power W	电压 Voltage V	频率 Frequency Hz	电流 Current A	启动转矩 Starting Torque mNm	额定转矩 Rated Torque mNm	额定转速 Rated Speed r/min	电容器容量 Capacitor μF
6K140GU-AFM	6K140A-AFM	30min	140	1ph 100	50	2.7	700	1080	1250	35
						3.0		870	1550	
6K140GU-EFM	6K140A-EFM	30min	140	1ph 110	60	1.80	700	850	1550	25
				1ph 120		1.95				
6K140GU-CFM	6K140A-CFM	30min	140	1ph 220	50	1.05	850	1040	1250	10
				1ph 230		1.15				
6K140GU-HFM	6K140A-HFM	30min	140	1ph 220	60	1.05	750	850	1550	-
				1ph 230		1.15				
6K140GU-SM	6K140A-SM	30min	140	3ph 220	50	0.85	2700	1080	1250	-
				3ph 230		0.75		2200	1550	

## ■ 调速电动机参数 SPEED CONTROL MOTOR SPECS

齿轮轴型 Pinion Shaft	圆轴型 Round Shaft	型号Model、类型 Type 导线型 Lead Wire Type	最大 输出功率 Output power W	电压 Voltage V	频率 Frequency Hz	调速范围 Speed Control Range r/min	容许转矩 Allowance Torque		启动转矩 Starting Torque mNm	电流 Current A	电容器容量 Capacitor μF
							1200/min mNm	90/min mNm			
6K140RU-AF	6K140RA-AF	140	1ph 100	50	60	90-1350	830	420	620	2.70	35
										3.00	
6K140RU-EF	6K140RA-EF	140	1ph 110	60	90-1650	830	450	620	1.80	25	
			1ph 120						1.95		
6K140RU-CF	6K140RA-CF	140	1ph 220	50	90-1350	830	420	620	1.05	10	
			1ph 230						1.15		
6K140RU-HF	6K140RA-HF	140	1ph 220	60	90-1650	830	450	620	1.05	10	
			1ph 230						1.15		

## ■ 装有减速器时的容许转矩 Gear Motor-Torque Table

减速器另售。中间减速器另售。

Gearhead and mid-gearbox can be sold separately.

■ 减速器型号中的□为减速比的数值。

Enter the gear ratio in the box(□) within the model name.

■ 颜色表示与电动机同一方向运转，其他则为相反方向。

The colored background indicates the same rotating direction of the motor while the rotating direction of others are opposite.

## 容许力矩单位 Allowance Torque Unit：上段 Upside (N.m) / 下段 Belowside (kgf.cm)

类型 Type 电动机/减速器 Motor/Gearhead	减速比 Gear Ratio	3	3.6	5	6	7.5	9	12.5	15	18	25	30	36	50	60	75	90	100	120	150	180	200		
		转速 Speed r/min	50Hz	500	417	300	250	200	166	120	100	83	60	50	41	30	25	20	16	15	12.5	10	8.3	7.5
6K140GU-AF□ 6K140GU-EF□ 6K140GU-SF□	6GU□K	50Hz	2.6	3.1	4.4	5.2	6.6	7.9	9.9	11.8	14.2	17.8	21.4	25.7	35.6	40	40	40	40	40	40	40	40	40
		50Hz	26.5	31.6	44.8	53.0	67.3	80.6	101	120	144	181	218	262	363	400	400	400	400	400	400	400	400	400
		50Hz	2.5	3.0	4.2	5.1	6.3	7.6	9.5	11.4	13.7	17.2	20.6	247	34.3	40	40	40	40	40	40	40	40	40
		50Hz	25.5	30.6	42.8	52.0	63.2	77.5	96.9	116	139	175	210	252	349	400	400	400	400	400	400	400	400	400

## ■ 外形图 (单位: mm) Dimensions(Unit mm)

减速器附有安装用螺丝。Mounting screws are included with gearhead.

### ● 导线型 Lead Wiring Type (感应/可逆/刹车电动机)

重量 Weight: 电动机 Motor: 5.0kg 减速器 Gearhead: 2.1kg

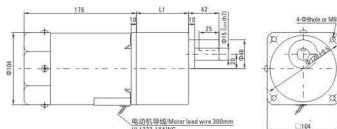

### ● 圆轴型 Round Shaft Type (感应/可逆/刹车电动机)

重量 Weight: 电动机 Motor: 5.93kg 减速器 Gearhead: 2.1kg

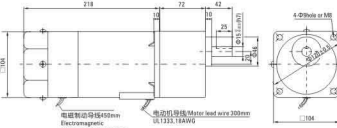

### ● 导线型 Lead Wiring Type (调速 Speed Control Motors)

重量 Weight: 电动机 Motor: 5.1kg 减速器 Gearhead: 2.1kg

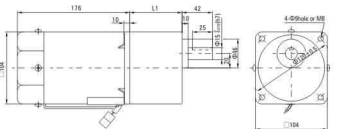

### ● 圆轴型的轴部分 Shaft Section Of Round Shaft Type

除重量及轴部外电动机外形与齿轮轴型相同。

Excluding weight and the shaft section motor shapes are the same as those of the pinion shaft type.

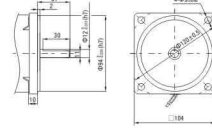

### ● 中间减速器 Decimal Gearhead

可安装在GU齿轮轴型上。Can be connected to GU pinion shaft type

电动机外形与齿轮轴型相同

SGU100K

重量 Weight: 0.6kg

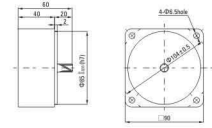

减速器型号 Gearhead Model	减速比 Gear Ratio	L1
6GU□K	3-200	72

### ● 减速器型号中的□为减速比的数值

Enter the gear ratio in the box(□) within the model name

● 带端子箱型 Terminal Box Type (感应/可逆 Induction/Reversible Motor)  
重量 Weight : 电动机 Motor : 5.15kg 减速器 Gearhead : 2.1kg

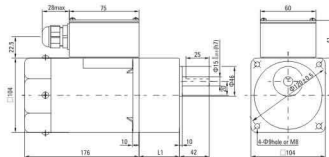

减速器型号 Gearhead Model	减速比 Gear Ratio	L1
6GU□K	3~200	72

● 减速器型号的□中为减速比的数值  
Enter the gear ratio in the box (□) within the model name

弧锥直角  
SPIRAL BEVEL RIGHT ANGLE

容许力矩单位 Allowance Torque Unit: 上段 Upside (N.m) / 下段 Belowside (kgf.cm)

机型Type 电动机/减速器 Motor/Gearhead	减速比Gear Ratio	3	3.6	5	6	7.5	9	12.5	15	18	25	30	3.6	50	60	75	90	100	120	150	180
6K140GU-AF□ 6K140GU-EF□ 6K140GU-CF□ 6K140GU-HF□ 6K140GU-SF□	50Hz	500	417	300	250	200	166	120	100	83	60	50	417	30	25	20	16	15	12	10	8
	60Hz	600	500	360	300	240	200	144	120	100	72	60	500	36	30	24	20	18	15	12	10
容许力矩 Allowance Torque	50Hz	1.99	2.39	3.31	3.98	4.97	6.63	9.21	11.0	13.3	18.4	22.1	26.5	33.1	39.8	49.7	59.6	60.0	60.0	60.0	60.0
	60Hz	2.03	24.3	33.8	40.6	50.7	67.6	93.9	113	135	188	225	271	338	406	507	600	600	600	600	600
容许力矩 Allowance Torque	50Hz	1.60	1.92	2.67	3.21	4.01	5.34	7.42	8.91	10.7	14.8	17.8	21.4	26.7	32.1	40.1	48.1	53.4	60.0	60.0	60.0
	60Hz	16.4	19.6	27.3	32.7	40.9	54.5	75.8	90.9	109	152	182	218	273	327	409	491	545	600	600	600

■ 感应尺寸图 Induction Type Drawing

6K140GU-AF□/6GU□RC 6K140GU-EF□/6GU□RC 6K140GU-CF□/6GU□RC 6K140GU-HF□/6GU□RC 6K140GU-SF□/6GU□RC  
6K140GU-AF□/6GU□RT 6K140GU-EF□/6GU□RT 6K140GU-CF□/6GU□RT 6K140GU-HF□/6GU□RT 6K140GU-SF□/6GU□RT

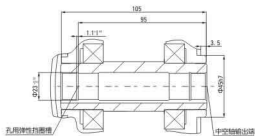
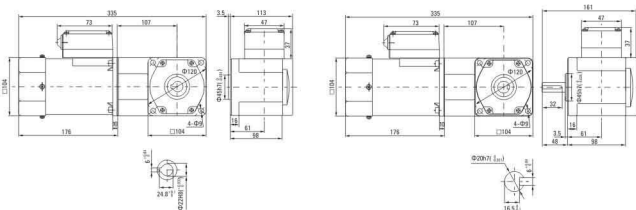

# 200W

交流减速电机 □104mm  
AC GEAR MOTOR

■ 感应电动机参数 INDUCTION MOTOR SPECS

型号Model - 类型 Type 上段齿轴型 Upper Pinion Shaft 下段齿轴型 Below Round Shaft	输出功率 Output power	电压 Voltage	频率 Frequency	电流 Current	启动转矩 Starting Torque	额定转矩 Rated Torque	额定转速 Rated Speed	电容器容量 Capacitor
导线型 Lead Wire Type 外形图Dimensions①	端子箱型 Terminal Box Type 外形图Dimensions②	W	V	Hz	A	mN.m	m/min	μF
6K200GU-AF (6K200A-AF)	6K200GU-AFT (6K200A-AFT)	200	1ph 100	50	3.2	900	1520	1250
				60	3.5		1230	
6K200GU-EF (6K200A-EF)	6K200GU-EFT (6K200A-EFT)	200	1ph 110 1ph 120	50	2.75	850	1230	1550
				60	2.65		1230	
6K200GU-CF (6K200A-CF)	6K200GU-CFT (6K200A-CFT)	200	1ph 220 1ph 230	50	1.40	1000	1520	1250
				60	1.40		1230	
6K200GU-HF (6K200A-HF)	6K200GU-HFT (6K200A-HFT)	200	1ph 220 1ph 230	50	1.20	3400	1520	1250
				60	1.0		2700	
6K200GU-SF (6K200A-SF)	6K200GU-SFT (6K200A-SFT)	200	3ph 220	50	1.20	3400	1520	1250
				60	1.0		2700	

■ 可逆刹车电动机参数 REVERSIBLE MOTOR SPECS

型号Model - 类型 Type 导线型 Lead Wire Type	额定 Rating	输出功率 Output power	电压 Voltage	频率 Frequency	电流 Current	启动转矩 Starting Torque	额定转矩 Rated Torque	额定转速 Rated Speed	电容器容量 Capacitor
齿轴轴型 Pinion Shaft	圆轴轴型 Round Shaft	W	V	Hz	A	mN.m	mN.m	r/min	μF
6R200GU-AFM	6R200A-AFM	30min	200	1ph 100	50	3.2	900	1385	1250
					60	3.5		1120	
6R200GU-EFM	6R200A-EFM	30min	200	1ph 110 1ph 120	50	2.75	850	1120	1550
					60	2.65		1120	
6R200GU-CFM	6R200A-CFM	30min	200	1ph 220 1ph 230	50	1.40	1100	1385	1250
					60	1.40		1000	
6R200GU-HFM	6R200A-HFM	30min	200	1ph 220 1ph 230	50	1.20	3400	1385	1250
					60	1.00		2700	

■ 调速电动机参数 SPEED CONTROL MOTOR SPECS

型号Model - 类型 Type 导线型 Lead Wire Type	最大 输出 功率 Output power	电压 Voltage	频率 Frequency	调速范围 Speed Control Range	容许转矩 Allowance Torque	启动转矩 Starting Torque	电流 Current	电容器容量 Capacitor
齿轴轴型 Pinion Shaft	圆轴轴型 Round Shaft	W	V	Hz	1200r/min mN.m	90r/min mN.m	A	μF
6K120RGU-AF	6K120RA-AF	120	1ph 100	50	90~1350	750	360	530
				60	90~1650		2.10	
6K120RGU-EF	6K120RA-EF	120	1ph 110 1ph 120	50	90~1650	750	360	520
				60	90~1650		2.50	
6K120RGU-CF	6K120RA-CF	120	1ph 220 1ph 230	50	90~1350	750	330	530
				60	90~1650		1.70	
6K120RGU-HF	6K120RA-HF	120	1ph 220 1ph 230	50	90~1650	750	360	530
				60	90~1650		0.95	





● 60W, 90W, 120W 凸缘安装型减速器 60W, 90W, 120W Flange Mounting Reducer

可安装在GU齿轮轴型上

Can be mounted on GU type gear shaft

SGU 凸缘

重量Weight: 1.5kg

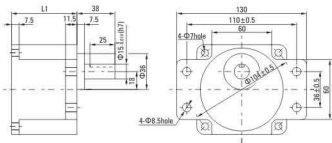

减速器型号 Gearhead Model	减速比 Gear Ratio	L1
6GU□X	3-200	72

● 减速器型号的 □ 中为减速比的数值  
Enter the gear ratio in the box (□) within the model name

■ 连接图 Wiring Diagram (感应电机)

● 运转方向指从电动机轴看来的方向。CW表示顺时针方向，CCW表示逆时针方向。

The direction of motor rotation is as viewed from the shaft end of motor. CW represents the clockwise direction, while CCW represents the counterclockwise direction.

● 表中所记型号为齿轮轴型，圆锥轴亦同。

Name indicated in the list is pinion shaft type, also valid for the equivalent round shaft type.

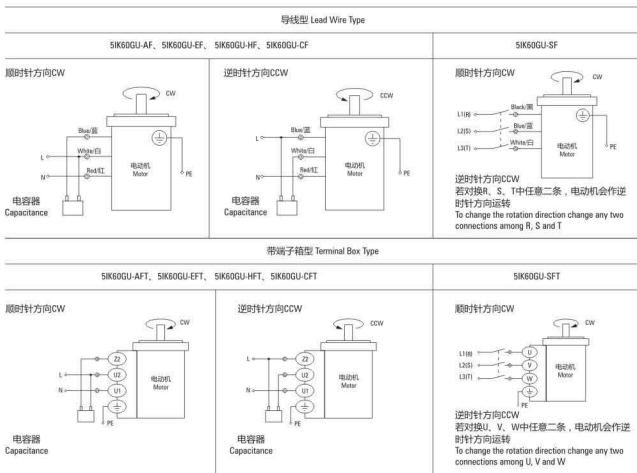

请注意 Note:

单相电动机运转方向的转换应在电动机停止后进行。

Change the direction of single-phase motor rotation only after bring the motor to a stop.

若在电动机运转时转换运转方向，可能发生无法转换运转方向或须费时较久的情况。

If an attempt is made to change the direction of rotation while the motor is rotating, motor may ignore reversing command or change its direction of rotation after some delay.

■ 连接图 Wiring Diagram (可逆电机)

● 运转方向指从电动机轴看来的方向。CW表示顺时针方向，CCW表示逆时针方向。

The direction of motor rotation is as viewed from the shaft end of motor. CW represents the clockwise direction, while CCW represents the counterclockwise direction.

● 表中所记型号为齿轮轴型，圆锥轴亦同。

Name indicated in the list is pinion shaft type, also valid for the equivalent round shaft type.

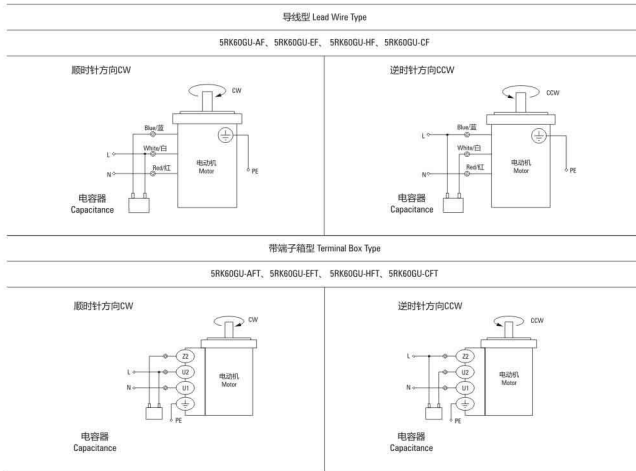

请注意 Note:

单相电动机运转方向的转换应在电动机停止后进行。

Change the direction of single-phase motor rotation only after bring the motor to a stop.

若在电动机运转时转换运转方向，可能发生无法转换运转方向或须费时较久的情况。

If an attempt is made to change the direction of rotation while the motor is rotating, motor may ignore reversing command or change its direction of rotation after some delay.

## ■ 连接图 Wiring Diagram (刹车电机)

• 运转方向指从电动机轴看来方向。CW表示顺时针方向，CCW表示逆时针方向。

The direction of motor rotation is as viewed from the shaft end of motor. CWV represents the clockwise direction, while CCW represents the counterclockwise direction.

• 表中所记名称为轴端类型，圆轴型亦同。Name indicated in the list is pinion shaft type, also valid for the equivalent round shaft type.

单相电动机 Single-phase Motor	
5RK60GU-AFM, 5RK60GU-EFM, 5RK60GU-CFM, 5RK60GU-HFM	

SW1为电动机的运行停止及电磁制动操作作用开关。(连动)

SW1 operates both motor and electromagnetic brake action. (Switched Simultaneously)

SW1设定于ON时，电磁制动解除，电动机开始运行。

The motor will rotate when SW1 is switched simultaneously to ON.

SW1设定于OFF时，电动机停止，电磁制动开始工作。

When SW1 is switched simultaneously to OFF, the motor stops immediately with the electromagnetic brake and holds the load.

在电动机停止状态下解除电磁制动时，应将SW1设定为非连动，而仅将黑色导线侧的触点设定为ON。

If you wish to release the brake while the motor is stopped, set the SW1 to off and connection point at the side of black lead to on.

运转方向。Direction of Rotation.

将SW2转换至CW侧时，电动机作顺时针方向运转。

To rotate the motor in a clockwise (CW) direction, turn SW2 to CW.

将SW2转换至CCW侧时，电动机作逆时针方向运转。

To rotate the motor in a counterclockwise (CCW) direction, turn SW2 to CCW.

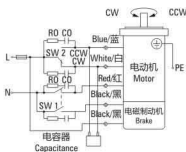

开关 符号 Switch No.	开关的触点容量 Capacitor of Switch Connection Point		参考 Note
	单相100V, 110/120V输入 Single-Phase 100 VAC, 110/120 VAC Input	单相220V, 230V输入 Single-Phase 200 VAC, 220/230 VAC Input	
SW1	AC125V 3A以上 (感性负载) 125 VAC 3A minimum (Inductive Load)	AC250V 1.5A以上 (感性负载) 250 VAC 1.5A A minimum (Inductive Load)	连动 Switched Simultaneously
SW2			

### 三相电动机 Three-phase Motor

5RK60GU-SFM

SW1为电动机的运行停止及电磁制动操作作用开关。(连动)

SW1 operates both motor and electromagnetic brake action. (Switched Simultaneously)

SW1设定于ON时，电磁制动解除，电动机开始运行。

The motor will rotate when SW1 is switched simultaneously to ON.

SW1设定于OFF时，电动机停止，电磁制动开始工作。

When SW1 is switched simultaneously to OFF, the motor stops immediately with the electromagnetic brake and holds the load.

在电动机停止状态下解除电磁制动时，应将SW1设定为非连动，而仅将黑色导线侧的触点设定为ON。

If you wish to release the brake while the motor is stopped, set the SW1 to off and connection point at the side of black lead to on.

运转方向。Direction of Rotation.

若对换R、S、T中任意二条，电动机会逆时针方向运转。

To change the rotation direction, change any two connections between R, S and T.

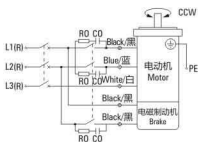

开关 符号 Switch No.	开关的触点容量 Capacitor of Switch Connection Point		参考 Note
	单相100V, 110/120V输入 Single-Phase 100 VAC, 110/120 VAC Input	单相220V, 230V输入 Single-Phase 200 VAC, 220/230 VAC Input	
SW1	AC250V 1.5A以上 (感性负载) 250 VAC 1.5 A minimum (Inductive Load)		连动 Switched Simultaneously

### 请注意 Notes:

• R0C0为吸收电源电压用R电路。[R0=5~200Ω, C0=0.1~0.2μF, 200WV (400WV)] 请使用选购配件EPCR1201-2。

• R0 and C0 indicate surge suppressor circuit. [R0=5~200Ω, C0=0.1~0.2 μF, 200 WV (400 WV)] EPCR1201-2 is available as an optional surge suppressor.

## ■ 连接图 Wiring Diagram (调速电机)

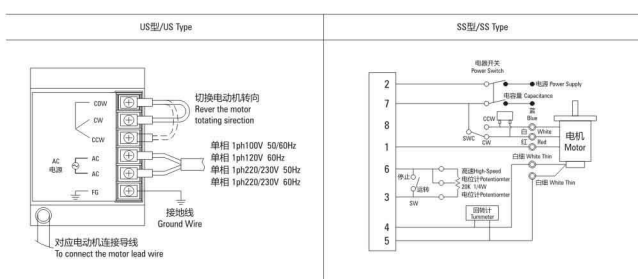

## ■ 组合型 Combination SS11、SS22 正、反转变速 Clockwise And Anti-clockwise Speed Change

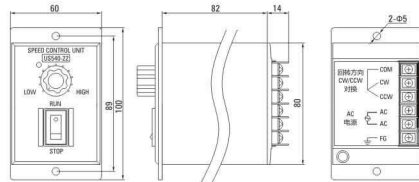

## ■ 分离器 Separation SS11、SS22 正、反转变速 Clockwise And Anti-clockwise Speed Change

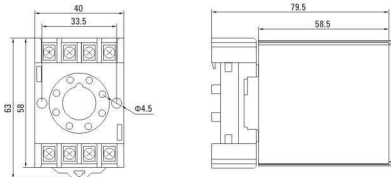

## DESCRIPTION OF DC MOTOR

## 直流电动机型号说明

## Z 5(5) D(W) 60-24-GU 30S

① ② ③ ④ ⑤ ⑥ ⑦

①	公司代码 Company code						电机种类
②	机座号 Code	2	3	4	5	55	6
	电机安装法兰 Mounting Flange mm	60×60	70×70	80×80	90×90	104×90	104×104
	机壳直径 Case Diameter mm	60	60	80	80	80	90
③	电机种类 Motor Type	D: 直流电机 (D: DC MOTOR) DW: 针对 60, 70 系列电机 D 后加 W 表示外置电刷电机 For 60, 70 series motor, DW refers to external brush motor					
④	输出功率 Output power	60: 60W					
⑤	电源电压 Voltage	24: 24V DC					
⑥	齿轴形状 Motor shaft type	GN: 普通型斜齿轴 GN: General Helical Gear A1: 铣键槽 A1: Milling Keyway GU: 加强型斜齿轴 GU: Reinforced Helical Gear A: 铣扁 A1: Flat Type					
⑦	电机转速 Speed	30S: 3000rpm					

备注: 如果电机需要配刹车器可在型号最后加-M符号, 如 Z5(5)D60-24GU-30S-M。  
Note: We use M to symbolise the brake, such as Z5(5)D60-24GU-30S-M。

## DESCRIPTION OF GEARBOX

## 减速器型号说明

## 5 GN 50 K

① ② ③ ④

①	型号尺寸 Model and Dimension	2:60mm 3:70mm 4:80mm 5:90mm 6:104mm				
	齿轮类型 Gear Type	GN: 普通型斜齿轴 GN: General Helical Gear GU: 加强型斜齿轴 GU: Reinforced Helical Gear				
③	减速比 Gear Ratio	50: 减速比 1:50 50: Gear ratio 1:50 10X 仅限于速比 1:10 的中间 减速比 10X refers to the mid gear ratio 1:10				
④	轴承类型 Bearing Type	K: 滚珠轴承对 GU 型方箱体标注为 KB K: Ball Bearing (Mark KB for Type GU square gearbox)				

6W 10W  
15W直流减速电机 □ 60mm  
DC GEAR MOTOR

## ■ 6W 电机性能参数 6W Motor Performance Parameters

型号 Model	电压 Voltage V	功率 Power W	空载参数 No-load Parameters		负载参数 Load Parameters			电刷寿命 Brush Life H	电机重量 Motor Weight kg
			转速 Speed r/min	电流 Current A	转速 Speed r/min	力矩 Torque mN.m	电流 Current A		
ZD06-12 □	12	6	3200	0.6 Max.	2950	19	0.8	2000	0.6
ZD06-12 □	12	6	3200	0.6 Max.	2950	19	0.8	2000	0.6
ZD06-24 □	24	6	3200	0.3 Max.	2950	19	0.5	2000	0.6
ZD06-24 □	24	6	3200	0.3 Max.	2950	19	0.5	2000	0.6
ZD06-90 □	90	6	3000	0.2 Max.	2800	20	0.3	2000	0.6
ZD06-90 □	90	6	3000	0.2 Max.	2800	20	0.3	2000	0.6

## ■ 10W 电机性能参数 10W Motor Performance Parameters

型号 Model	电压 Voltage V	功率 Power W	空载参数 No-load Parameters		负载参数 Load Parameters			电刷寿命 Brush Life H	电机重量 Motor Weight kg
			转速 Speed r/min	电流 Current A	转速 Speed r/min	力矩 Torque mN.m	电流 Current A		
ZD10-12 □	12	10	3200	1.0 Max.	2800	34	2.0	2000	0.7
ZD10-12 □	12	10	3200	1.0 Max.	2800	34	2.0	2000	0.7
ZD10-24 □	24	10	3300	0.5 Max.	3000	32	0.9	2000	0.7
ZD10-24 □	24	10	3300	0.5 Max.	3000	32	0.9	2000	0.7
ZD10-90 □	90	10	3200	0.3 Max.	2800	34	0.6	2000	0.7
ZD10-90 □	90	10	3200	0.3 Max.	2800	34	0.6	2000	0.7

## ■ 15W 电机性能参数 15W Motor Performance Parameters

型号 Model	电压 Voltage V	功率 Power W	空载参数 No-load Parameters		负载参数 Load Parameters			电刷寿命 Brush Life H	电机重量 Motor Weight kg
			转速 Speed r/min	电流 Current A	转速 Speed r/min	力矩 Torque mN.m	电流 Current A		
ZD15-12 □	12	15	3200	0.8 Max.	2950	48	2.0	2000	0.9
ZD15-12 □	12	15	3200	0.8 Max.	2950	48	2.0	2000	0.9
ZD15-24 □	24	15	3300	0.4 Max.	3000	48	1.0	2000	0.9
ZD15-24 □	24	15	3300	0.4 Max.	3000	48	1.0	2000	0.9
ZD15-90 □	90	15	3200	0.2 Max.	3000	48	0.4	2000	0.9
ZD15-90 □	90	15	3200	0.2 Max.	3000	48	0.4	2000	0.9

■ 电机电压、功率及转速可在配件尺寸等条件下根据客户要求定制。

Motor voltage, power and speed will be customized according to his requirement under the allowed circumstance of adpable dimension.

■ 0后如加W(ZD06-12GN表示外置电刷轴电机, 如无W则为标准内置电刷轴电机); 外置电刷电机, 用户可自行在外部更换电刷; 内置电刷电机更换电刷时需将电机拆装后方可更换。

We use W after 0 in the model to express the external brush motor, such as ZD06-12GN. If no W, it means the standard internal brush motor. For external brush motor, you can replace the brush directly. For internal ones, we need to disassemble the motor first.

## 容许力矩单位 Allowance Torque Unit : 上段 Upside ( N.m ) / 下段 Belowside ( kgf.cm )

型号 Type	减速比 Gear Ratio	3	3.6	5	6	7.5	9	10	12.5	15	18	20	25	30	36	40	50	60	75	90	100	120	150	180	200
ZD08-24GN	转速 Speed r/min	933	819	590	452	393	328	295	236	197	164	148	118	98	82	74	59	49	39	33	30	25	20	16	15
	ZGN□K	0.05	0.06	0.08	0.09	0.12	0.14	0.16	0.20	0.24	0.28	0.28	0.35	0.42	0.51	0.57	0.71	0.76	0.96	1.15	1.27	1.53	1.91	2.29	2.55
	0.46	0.56	0.77	0.93	1.16	1.39	1.54	1.93	2.31	2.78	2.78	3.47	4.15	5.00	5.55	6.94	7.49	9.37	11.2	12.5	15.0	18.7	22.5	25.0	
ZD10-24GN	转速 Speed r/min	1000	833	600	500	400	333	300	240	200	167	150	120	100	83	75	60	50	40	33	30	25	20	17	15
	ZGN□K	0.08	0.09	0.13	0.15	0.19	0.23	0.26	0.32	0.39	0.46	0.58	0.70	0.84	0.93	1.16	1.25	1.75	1.88	2.09	2.51	3.00	3.00	3.00	3.00
	0.76	0.91	1.26	1.52	1.90	2.27	2.53	3.16	3.79	4.55	4.55	5.69	6.82	8.19	9.10	11.4	12.3	15.4	18.4	20.5	24.6	30.0	30.0	30.0	
ZD15-24GN	转速 Speed r/min	1000	833	600	500	400	333	300	240	200	167	150	120	100	83	75	60	50	40	33	30	25	20	17	15
	ZGN□K	0.12	0.14	0.19	0.23	0.29	0.35	0.39	0.48	0.58	0.70	0.87	1.04	1.25	1.39	1.74	1.88	2.35	2.82	3.00	3.00	3.00	3.00	3.00	3.00
	1.14	1.36	1.90	2.27	2.84	3.41	3.79	4.74	5.69	6.82	8.53	10.23	12.28	13.65	17.1	18.4	23.0	27.6	30.0	30.0	30.0	30.0	30.0	30.0	

## 外形图 (单位 mm) Dimensions (Unit mm)

减速器附有安装用螺丝 Mounting screws are included with gearhead.

### ● 导轨型 Lead Wiring Type

6W 重量 Weight : 电动机 Motor : 0.6kg  
10W 重量 Weight : 电动机 Motor : 0.7kg

减速器 Gearhead : 0.4kg  
减速器 Gearhead : 0.4kg

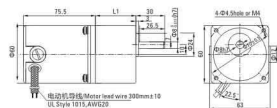
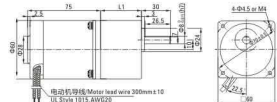

### ● 导轨型 Lead Wiring Type

15W 重量 Weight : 电动机 Motor : 0.9kg

减速器 Gearhead : 0.4kg

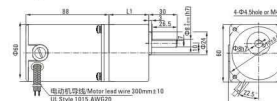
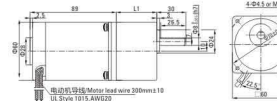

### ● 圆轴型的轴部分 Shaft Section Of Round Shaft Type

除重量及轴部分电动机外形与齿轮轴型相同。  
Excluding weight and the shaft section motor shape are the same as those of the pinion shaft type.

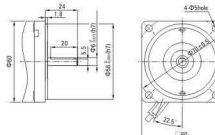

### ● 中间减速器 Decimal Gearhead

可安装在GN齿轴型上 Can be connected to GN pinion shaft type  
电动机外形与齿轮轴型相同  
电动机 Motor : 0.24kg  
重量 Weight : 0.24kg

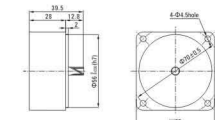

减速器型号 Gearhead Model	减速比 Gear Ratio	L1
ZGN□K	3-18	32
	25-200	41

Enter the gear ratio in the box (□) within the model name

● 减速器型号的□中为减速比的数值



# 25W

直流减速电机 □70mm  
DC GEAR MOTOR

## 电机性能参数 Motor Performance Parameters

型号 Model	电压 Voltage	功率 Power	空载参数 No-load Parameters		负载参数 Load Parameters		电刷寿命 Brush Life	电机重量 Motor Weight	
	V	W	转速 Speed r/min	电流 Current A	转速 Speed r/min	力矩 Torque mN.m			电流 Current A
ZD25-12 □	12	25	3300	1.0 Max.	3000	80	3.5	2000	1.0
ZD25-12 □	12	25	3300	1.0 Max.	3000	80	3.5	2000	1.0
ZD25-24 □	24	25	3200	0.5 Max.	2800	85	1.6	2000	1.0
ZD25-24 □	24	25	3200	0.5 Max.	2800	85	1.6	2000	1.0
ZD25-90 □	90	25	3100	0.3 Max.	2700	88	0.6	2000	1.0
ZD25-90 □	90	25	3100	0.3 Max.	2700	88	0.6	2000	1.0

● 电机电压、功率及转速可在配件尺寸等条件下根据客户要求定制。

Motor voltage, power and speed will be customized according to his requirement under the allowed circumstance of adoptable dimension.

● 0后如加W即ZD25W-12GN表示外置电刷齿轴电机，如无W则为标准内置电刷齿轴电机；外置电刷电机，用户可自行在外进行更换电刷；内置电刷电机更换电刷时需将电机拆开后方可更换。

We use W after 0 in the model to express the external brush motor, such as ZD25W-12GN. If no W, it means the standard internal brush motor. For external brush motor, you can replace the brush directly. For internal ones, we need to disassembly it for first.

## 装有减速器时的容许转矩 Gear Motor-Torque Table

● 减速器另售：中间减速器另售。

Gearheads are sold separately. Decimal gearheads are not available.

● 减速器型号的□中为减速比的数值。

Enter the gear ratio in the box (□) within the model name.

● □中颜色表示与电动机同一方向旋转，其他则为相反方向。

The colored background (□) indicates the same rotating direction of the motor while the rotating direction of others are opposite.

● 转速是以电动机的额定转速为基准乘以减速比而算出来的数值。实际转速将随负载大小变化而有所数值减少2%~20%左右。

The speed is calculated by dividing the motor's synchronous speed by the gear ratio. The actual speed is 2%~20% less than the displayed value, depending on the size of the load.

● 希望以大于下表的减速比进行进一步减速时，可在电动机与减速器之间安装减速比为10的中间减速器。

这时的容许转矩为5N.m。

To reduce the speed beyond the gear ratio in the table, attach a decimal gearhead (gear ratio:10) between the gearhead and motor. In that case, the permissible torque is 5N.m.

## 容许力矩单位 Allowance Torque Unit : 上段 Upside ( N.m ) / 下段 Belowside ( kgf.cm )

型号 Type	减速比 Gear Ratio	3	3.6	5	6	7.5	9	10	12.5	15	18	20	25	30	36	40	50	60	75	90	100	120	150	180	200
ZD25-24GN	转速 Speed r/min	933	778	560	467	373	311	280	224	187	156	140	112	93	78	70	56	47	37	31	28	23	19	16	14
	3GN□K	0.21	0.25	0.35	0.41	0.52	0.62	0.69	0.86	1.04	1.24	1.24	1.55	1.86	2.24	2.49	3.11	3.73	4.66	5.00	5.00	5.00	5.00	5.00	5.00
		2.03	2.44	3.38	4.06	5.08	6.09	6.77	8.46	10.2	12.2	12.2	15.2	18.3	21.9	24.4	30.3	36.6	45.7	50.0	50.0	50.0	50.0	50.0	

### 外形图 (单位 mm) Dimensions (Unit mm)

减速器附有安装用螺丝 Mounting screws are included with gearhead.

#### ● 导线型 Lead Wiring Type

重量 Weight : 电动机 Motor : 1.0kg 减速器 Gearhead : 0.55kg

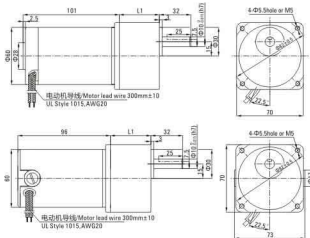

减速器型号 Gearhead Model	减速比 Gear Ratio	L1
3GN□K	3-18	32
	25-200	42

● 减速器型号的□中为减速比的数值 Enter the gear ratio in the box (□) within the model name

#### ● 圆轴型的转轴部分 Shaft Section Of Round Shaft Type

除重量及轴部外形与齿轮轴型相同。  
Excluding weight and the shaft section motor shape are the same as those of the pinion shaft type.

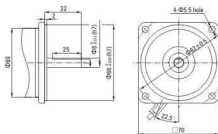

#### ● 中间减速器 Decimal Gearhead

可安装在GN齿轮轴型上 Can be connected to GN pinion shaft type  
电动机外形与齿轮轴型相同  
Motor shape is the same as the pinion shaft type

重量 Weight : 0.31kg

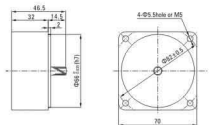

# 25W 40W

直流减速电机 □80mm  
DC GEAR MOTOR

### 25W 电机性能参数 25W Motor Performance Parameter

型号 Model	电压 Voltage V	功率 Power W	空载参数 No-load Parameters		负载参数 Load Parameters			电刷寿命 Brush Life H	电机重量 Motor Weight kg
			转速 Speed r/min	电流 Current A	转速 Speed r/min	力矩 Torque mNm	电流 Current A		
Z4D25-12□	12	25	3200	1.4 Max.	3100	77	3.6	2000	1.7
Z4D25-24□	24	25	3000	0.7 Max.	2850	84	1.7	2000	1.7
Z4D25-90□	90	25	3200	0.2 Max.	3000	80	0.5	2000	1.7

### 40W 电机性能参数 40W Motor Performance Parameter

型号 Model	电压 Voltage V	功率 Power W	空载参数 No-load Parameters		负载参数 Load Parameters			电刷寿命 Brush Life H	电机重量 Motor Weight kg
			转速 Speed r/min	电流 Current A	转速 Speed r/min	力矩 Torque mNm	电流 Current A		
Z4D40-12□	12	40	3100	2.0 Max.	2800	136	5.2	2000	1.8
Z4D40-24□	24	40	3100	0.8 Max.	3000	127	2.1	2000	1.8
Z4D40-90□	90	40	3200	0.3 Max.	3000	127	0.7	2000	1.8

● 电机电压、功率及转速可在配件尺寸等条件下根据客户要求定制。

Motor voltage, power and speed will be customized according to his requirement under the allowed circumstance of adoptable dimension.

### ■ 装有减速器时的容许转矩 Gear Motor-Torque Table

- 减速器另售 中间减速器另售。  
Gearheads are sold separately, Decimal gearheads are not available.
- 减速器型号的□中为减速比的数值。  
Enter the gear ratio in the box(□) within the model name.
- □□色表示与电动机同一方向运转, 其他则为相反方向。  
The colored background □□ indicates the same rotating direction of the motor while the rotating direction of others are opposite.
- 转速是以电动机的额定转速为基准除以减速比而算出来的数值。实际转速将随负载大小变化而比所示数值减少2%~20%左右。  
The speed is calculated by dividing the motor's synchronous speed by the gear ratio. The actual speed is 2%~20% less than the displayed value, depending on the size of the load.
- 希望以大于下表中的减速比进行进一步减速时, 可在电动机与减速机之间安装减速比为10的中间减速器。  
这时的容许转矩为8Nm。  
To reduce the speed beyond the gear ratio in the table, attach a decimal gearhead(gear ratio:10)between the gearhead and motor. In that case, the permissible torque is 8Nm.



■ 容许力矩单位 Allowance Torque Unit : 上段 Upside ( N.m ) / 下段 Belowside ( kgf.cm )

型号 Type	减速比 Gear Ratio	3	3.6	5	6	7.5	9	10	12.5	15	18	20	25	30	36	40	50	60	75	90	100	120	150	180	200
Z5D40-24GN	转速 Speed /r/min	933	778	560	467	373	311	280	224	187	156	140	112	93	78	70	56	47	37	31	28	23	19	16	14
	5GN□KB	0.33	0.40	0.55	0.66	0.83	0.99	1.11	1.39	1.66	1.79	1.99	2.49	2.99	3.58	4.48	5.37	6.71	8.06	8.95	10.0	10.0	10.0	10.0	10.0
		3.25	3.90	5.41	6.50	8.12	9.75	10.0	13.5	16.2	17.5	18.5	24.4	29.2	35.1	35.1	43.9	52.6	65.8	78.9	87.7	100	100	100	100
Z5D60-24GU	转速 Speed /r/min	933	778	560	467	373	311	280	224	187	156	140	112	93	78	70	56	47	37	31	28	23	19	16	14
	5GU□KB	0.50	0.60	0.83	0.99	1.24	1.49	1.49	1.86	2.24	2.69	2.69	3.36	4.03	4.83	5.37	6.71	8.06	10.1	10.9	12.1	14.5	18.1	20.0	20.0
		4.87	5.85	8.12	9.75	12.2	14.6	14.6	18.3	21.9	26.3	26.3	32.9	39.5	47.4	52.6	65.8	78.9	98.7	107	118	142	178	200	200
Z5D90-24GU	转速 Speed /r/min	933	778	560	467	373	311	280	224	187	156	140	112	93	78	70	56	47	37	31	28	23	19	16	14
	5GU□KB	0.75	0.90	1.24	1.49	1.86	2.24	2.24	2.80	3.36	4.03	4.03	5.03	6.04	7.25	8.06	10.1	12.4	15.1	16.3	18.1	20.0	20.0	20.0	20.0
		7.31	8.77	12.2	14.6	18.3	21.9	21.9	27.4	32.9	39.5	39.5	49.3	59.2	71.1	78.9	98.7	118	148	160	178	200	200	200	200
Z5D120-24GU	转速 Speed /r/min	867	722	520	433	347	289	260	208	173	144	130	104	87	72	65	52	43	35	29	26	22	17	14	13
	5GU□KB	1.07	1.29	1.79	2.14	2.68	3.21	3.21	4.02	4.82	5.78	5.78	7.23	8.68	10.4	11.6	14.5	17.4	20.0	20.0	20.0	20.0	20.0	20.0	20.0
		10.5	12.6	17.5	21.0	26.2	31.5	31.5	39.4	47.2	56.7	56.7	70.9	85.0	102	113	142	170	200	200	200	200	200	200	200
Z5D250-24GU	转速 Speed /r/min	1000	833	600	500	400	333	300	240	200	167	150	120	100	83	75	60	50	40	33	30	25	20	17	15
	5GU□KB	1.93	2.32	3.22	3.87	4.83	5.80	5.80	7.25	8.70	10.4	10.4	13.1	15.7	18.8	20.0	20.0	20.0	20.0	20.0	20.0	20.0	20.0	20.0	20.0
		19.0	22.7	31.6	37.9	47.4	56.9	56.9	71.1	85.3	102	102	128	154	184	200	200	200	200	200	200	200	200	200	200

■ 外形图 (单位 mm) Dimensions(Unit mm)

减速器附有安装用螺丝 Mounting screws are included with gearhead.

● 导线型 Lead Wiring Type

40W 重量 Weight : 电动机 Motor : 1.9kg 减速器 Gearhead : 1.5kg

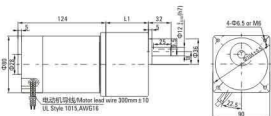

60W/90W/120W 重量 Weight : 电动机 Motor : 2.2kg 减速器 Gearhead : 1.5kg

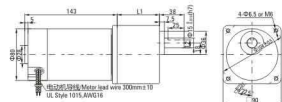

● 圆轴型的轴部分 Shaft Section Of Round Shaft Type

除重量及轴部外形与电动机外形与齿轮轴型相同, Excluding weight and the shaft section motor shape are the same as those of the pin shaft type.

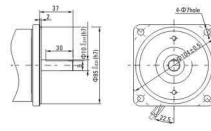
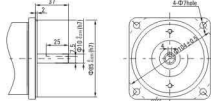

250W 重量 Weight : 电动机 Motor : 3.2kg 减速器 Gearhead : 1.5kg

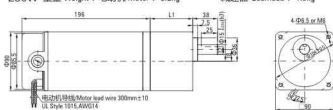

40W

减速器型号 Gearhead Model	减速比 Gear Ratio	L1
5GN□KB	3-18	32
	25-200	42.5

60W/90W/120W/250W

减速器型号 Gearhead Model	减速比 Gear Ratio	L1
5GU□KB	3-200	65.5

● 减速器型号的□中为减速比的数值 Enter the gear ratio in the box (□) within the model name

● 凸缘安装型减速器 Flange Mounting Reducer

可安装在GU齿轴型上 Can be mounted on GU type gear shafts 5GU□KB 重量 Weight: 1.5kg 60W/90W/120W/250W

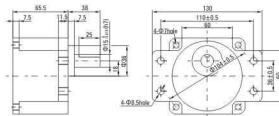

● 键 • 键槽 (减速器附件)

Key • Keyway (The Key is Included With The Gearhead)



● 中间减速器 Decimal Gearhead

可安装在GN齿轴型上 Can be connected to GN pinion shaft type 电动机外形与齿轴型相同 Motor shape is the same as gear shaft type 5GN□KB 40W 重量 Weight : 0.41kg

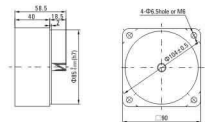

60W/90W/120W/250W 重量 Weight : 0.651kg

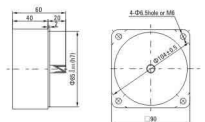





# 250W

直流减速电机 □ 104mm  
DC GEAR MOTOR

## 电机性能参数 Motor Performance Parameters

型号 Model	电压 Voltage		功率 Power		空载参数No-load Parameters			负载参数Load Parameters			电机寿命 Brush Life	电机重量 Motor Weight
	V	W	r/min	A	转速Speed	力矩Torque	电流Current	r/min	mN.m	A		
Z6D250-24 □	24	250	3400	3.0 Max.	3000	796	16.0	2000			3.2	
Z6D250-90 □	90	250	3300	1.0 Max.	3000	796	4.0	2000			3.2	
Z6D250-220 □	220	250	3300	0.8 Max.	3000	796	2.0	2000			3.2	

电机电压、功率及转速可在配件尺寸等条件下根据客户要求定制。

Motor voltage, power and speed will be customized according to his requirement under the allowed circumstance of adaptable dimension.

## 装有减速器时的容许转矩 Gear Motor-Torque Table

- 减速器另售 中间减速器另售。  
Gearheads are sold separately. Decimal gearheads are not available.
- 减速器型号的□中为减速比的数值。  
Enter the gear ratio in the box (□) within the model name.
- 色表示与电动机同一方向运转，其他则为相反方向。  
The colored background □ indicates the same rotating direction of the motor while the rotating direction of others are opposite.
- 转速是以电动机的额定转速为基准除以减速比再算出来的数值。实际转速将随负载大小变化比所示数值减少2%~20%左右。  
The speed is calculated by dividing the motor's synchronous speed by the gear ratio. The actual speed is 2%~20% less than the displayed value, depending on the size of the load.
- 希望以大于下表的减速比进行进一步减速时，可在电动机与减速机之间安装减速比为10的中间减速机。  
这时的容许转矩为40N.m。  
To reduce the speed beyond the gear ratio in the table, attach a decimal gearhead(gear ratio:10)between the gearhead and motor. In that case, the permissible torque is 40N.m.

## 容许力矩单位 Allowance Torque Unit : 上段 Upside ( N.m ) / 下段 Belowside ( kgf.cm )

型号 Type	减速比 Gear Ratio	3	3.6	5	6	7.5	9	12.5	15	18	25	30	36	50	60	75	90	100	120	150	180	200	
Z6D250-24GN	转速 Speed r/min	1000	833	600	500	400	333	240	200	166	120	100	83	60	50	40	33	30	25	20	16	15	
	6GU□K	1.93	2.32	3.22	3.87	4.83	5.80	7.25	8.70	10.4	13.1	15.7	18.8	26.1	31.3	39.2	40.0	40.0	40.0	40.0	40.0	40.0	40.0
		19.0	22.7	31.6	37.9	47.4	56.9	71.1	85.3	102	128	154	184	256	307	384	400	400	400	400	400	400	400

## 外形图 (单位 mm) Dimensions(Unit mm)

减速器附有安装用螺丝 Mounting screws are included with gearhead.

● 导线型 Lead Wiring Type

重量 Weight : 电动机 Motor : 3.2kg

减速机 Gearhead : 1.5kg

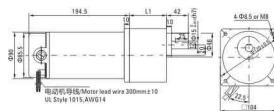

减速器型号 Gearhead Model	减速比 Gear Ratio	L1
6GU□K	3~200	72

● 减速器型号的□中为减速比的数值

Enter the gear ratio in the box (□) within the model name

● 键 Key (减速器附件)

Key #Keyway (The Key is Included With The Gearhead)



● 圆轴型的轴部分 Shaft Section Of Round Shaft Type

除重量及轴部分电动机外形与齿轮型相同。

Excluding weight and the shaft section motor shape are the same as those of the pinion shaft type.

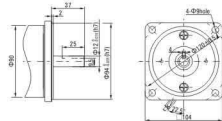



■ 外形图 (单位:mm) Dimensions(Unit:mm) 40W

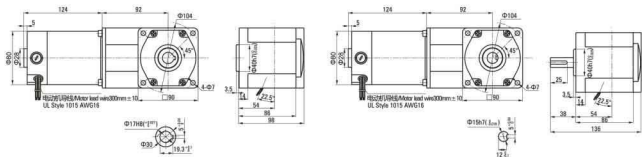

■ 外形图 (单位:mm) Dimensions(Unit:mm) 60W/90W/120W

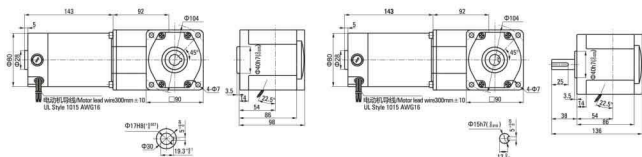

■ 外形图 (单位:mm) Dimensions(Unit:mm) 250W

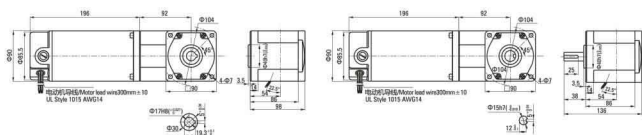

# 250W

直流弧锥直角减速电机 □104mm  
DC RIGHT ANGLE GEAR MOTOR

■ 装有减速机时的容许转矩 Gear Motor-Torque Table

- 减速机中间减速机省略。 Gearhead and intermediate gearhead are sold separately.
- 减速机后名称□中为减速比的数值。 Enter the reduction ratio into the blank(□) within the model name.
- □颜色表示分别从电动机轴输出和减速机轴输出时，电机轴与输出轴转向为反向运转。其他则为同一方向运转。  
□ Indicates the opposite rotating direction between motor shaft and gearbox shaft while others are in same direction.
- 转速是以电动机的额定转速为基准除以减速比而算出来的数值。实际转速将随负载大小变化而比所示数值减少2%~20%左右。  
The speed is calculated by dividing the motor's synchronous speed by the reduction ratio. The actual speed is 2%~20% less than the displayed value, depending on the size of the load.
- 希望以大于下表的减速比进行进一步减速时，可在电动机与减速机之间安装减速比为10的中间减速机。这时的容许转矩为60N·m。  
To reduce the speed beyond the reduction ratio in the following table, attach an intermediate gearhead (reduction ratio: 10) between the reducer and motor. In that case, the permissible torque is 60N·m.

■ 容许力矩单位 Allowance Torque Unit: 上段 Upside (N.m) / 下段 Belowside (kgf.cm)

机型Type 电动机/减速机 Motor/Gearhead	减速比Gear Ratio	3	3.6	5	6	7.5	9	12.5	15	18	25	30	36	50	60	75	90	100	120	150	180
转速Speed r/min		1000	833	600	500	400	333	240	200	166	120	100	83	60	50	40	33	30	25	20	16
Z8D250-24GU-30S	6GU1RC/ 6GU1RT	1.57	1.88	2.61	3.13	3.92	9.83	13.6	8.70	10.4	14.5	17.4	20.9	26.1	31.3	39.2	47.0	52.2	60.0	60.0	60.0
		16.0	19.2	26.6	3.19	40.0	100	139	88.7	106	148	177	213	266	319	340	479	532	600	600	600

■ 外形图 (单位:mm) Dimensions(Unit:mm)

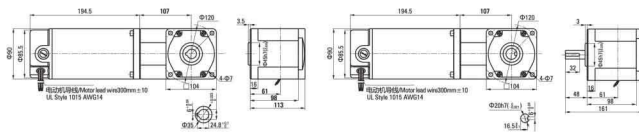





# 25W

直流无刷减速电机 □60mm  
BLDC GEAR MOTOR

### ■ 低压无刷电机性能参数 Low Voltage Motor Parameters

型号 Model	电压 Voltage V	空载电流 No-load Current A	空载转速 No-load Speed RPM	额定功率 Rated Power W	额定电流 Rated Current A	额定转速 Rated Speed RPM	额定转矩 Rated Torque N.m	防护等级 IP
Z2BLD25-24□	24	0.60	3900	25	2.0	3000	0.08	20
Z2BLD25-36□	36	0.45	3600	25	1.5	3000	0.08	20
Z2BLD25-48□	48	0.30	3400	25	1.0	3000	0.08	20

### ■ 高压无刷电机性能参数 High Voltage Motor Parameters

型号 Model	电压 Voltage V	频率 Frequency Hz	额定功率 Rated Power W	额定电流 Rated Current A	额定转速 Rated Speed RPM	额定转矩 Rated Torque N.m	防护等级 IP
Z2BLD10-220GN	220-230	50/60	10	0.26	2500	0.036	44
	100-120	50/60	10	0.50	2500	0.036	44
Z2BLD15-220GN	220-230	50/60	15	0.30	2500	0.056	44
	100-120	50/60	15	0.60	3000	0.056	44
Z2BLD25-220GN	220-230	50/60	25	0.30	2500	0.100	44
	100-120	50/60	25	0.60	2500	0.100	44

● 电机电压、功率及转速可在配件尺寸等条件下根据客户要求定制。  
Motor voltage, power and speed will be customized according to his request under the allowed circumstance of adoptable dimension.

### ■ 种类 Type

#### ● 低压电动机 Low Voltage Motor

机型 Type	型号 Model	
	齿轮轴型 Pinion Shaft	圆轴型 Round Shaft
导线型 Lead Wire Type	Z2BLD25-24GN	Z2BLD25-24A
	Z2BLD25-36GN	Z2BLD25-36A
	Z2BLD25-48GN	Z2BLD25-48A

#### ● 高压电动机 High Voltage Motor

机型 Type	型号 Model	
	齿轮轴型 Pinion Shaft	圆轴型 Round Shaft
导线型 Lead Wire Type	Z2BLD10-220GN	Z2BLD10-220A
	Z2BLD15-220GN	Z2BLD15-220A
	Z2BLD25-220GN	Z2BLD25-220A

#### ● 平行轴减速器 (另售) Parallel Shaft Gearhead (Sold Separately)

减速器种类 Gearhead Type	减速器型号 Gearhead Model	减速比 Gear Ratio
长寿命 ● 低噪音 Long Life ● Low Noise	2GN□K	3, 3.6, 5, 6, 7.5, 9, 12.5, 15, 18, 25, 30, 36, 50, 60, 75, 90, 100, 120, 150, 180, 200

#### ● 减速器型号的 □ 中为减速比的数值

Enter the gear ratio in the box within the model name

### ■ 装有减速器时的容许转矩 Gear Motor-torque Table

- 减速器另售，中间减速器另售。  
Gearhead and mid-gearbox can be sold separately
- 减速器型号的 □ 中为减速比的数值。  
Enter the gear ratio in the box ( ) within the model name.
- □ 色表示与电动机同一方向运转，其他则为相反方向。  
The colored background □ indicates the same rotating direction of the motor while the rotating direction of others are opposite.
- 转速是以电动机的额定转速为基准除以减速比而算出来的数值。实际转速将随负载大小变化而比所示数值减少2%~20%左右。  
The speed is calculated by dividing the motor's synchronous speed by the gear ratio. The actual speed is 2%~20% less than the displayed value, depending on the size of the load.
- 希望以大于下表中的减速比进行进一步减速时，可在电动机与减速器之间安装减速比为10的中间减速器。这时的容许转矩为3N·m。To reduce the speed beyond the gear ratio in the table, attach a decimal gearhead(gear ratio:10)between the gearhead and motor. In that case, the permissible torque is 3N·m.

### ■ 容许力矩单位 Allowance Torque Unit: 上段 Upside(N.m) / 下段 Belowside(kg/cm)

减速比 Gear Ratio	3	3.6	5	6	7.5	9	12.5	15	18	25	30	36	50	60	75	90	100	120	150	180	200
输出转速 r/min Out put shaft speed	1000	830	600	500	400	330	240	200	166	120	100	83	60	50	40	33	30	25	20	16	15
允许力矩 N.m Allowance Torque	0.19	0.23	0.32	0.38	0.48	0.58	0.81	0.97	1.16	1.44	1.73	2.07	2.52	3.00	3.00	3.00	3.00	3.00	3.00	3.00	3.00

### ■ 外形图 (单位 mm) Dimensions(Unit mm)

减速器附有安装用螺丝Mounting screws are included with gearhead.

#### ● 导线型 Lead Wiring Type

重量 Weight: 电动机 Motor: 0.5kg 减速器 Gearhead: 0.48kg

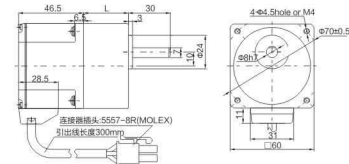

#### ● 圆轴型的转轴部分 Shaft Section Of Round Shaft Type

除重量及轴部外形电动机外形与齿轮轴型相同。  
Excluding weight and the shaft section motor shape are the same as those of the pinion shaft type.

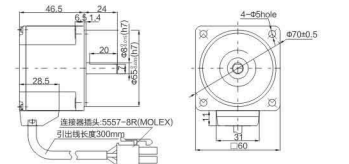

电动机型号 Motor Model	减速器型号 Gearhead Model	减速比 Gear Ratio	L尺寸 Dimension
Z2BLD25-□GN	2GN□K	3-18	32
		25-200	41

#### ● 减速器型号的 □ 中为减速比的数值

Enter the gear ratio in the box ( ) within the model name

#### ● 中间减速器 Decimal Gearhead

可安装在GN齿轴型上。  
Can be connected to GN pinion shaft type 2GN10XK  
重量 Weight: 0.2kg

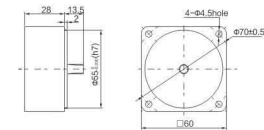

#### ● 接线孔对应信号说明 Wire Plug hole Corresp-onding Signal Explanation

plug hole	1	2	3	4
signal	U	W	Hz	Hu
plug hole	5	6	7	8
signal	V	GND	Hw	Vcc

## 60系列 60 SERIES

### 60L型减速器 60 Pressure L Type Reducer

#### 外形图 (单位mm) Dimensions(Unit mm)

减速器附有安装用螺丝 Mounting screws are included with gearhead.

#### 导线型 Lead Wiring Type

重量 Weight: 电动机 Motor: 0.9kg 减速器: Gearhead 0.48kg

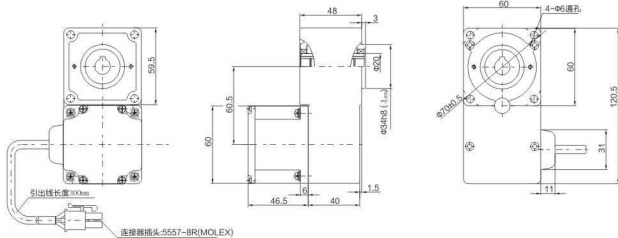

#### 键 - 键槽 (减速器附件)

Key - Keyway (The Key is Included With The Gearhead)



#### 接线插孔对应信号说明 Wire Plug hole Corr esp - ending Signal Explanation

plug hole	1	2	3	4
signal	U	W	Hz	Hu
plug hole	5	6	7	8
signal	V	GND	Hw	Vcc



# 60W

直流无刷减速电机 □80mm  
BLDC GEAR MOTOR

#### ■ 低压无刷电机性能参数 Low Voltage Motor Parameters

型号 Model	电压 Voltage V	空载电流 No-load Current A	空载转速 No-load Speed RPM	额定功率 Rated Power W	额定电流 Rated Current A	额定转速 Rated Speed RPM	额定转矩 Rated Torque N.m	防护等级 Grade Protection IP
Z4BLD60-24□	24	0.60	3900	60	3.5	3000	0.19	20
Z4BLD60-36□	36	0.45	3600	60	2.4	3000	0.19	20
Z4BLD60-48□	48	0.30	3400	60	1.8	3000	0.19	20

#### ■ 高压无刷电机性能参数 High Voltage Motor Parameters

型号 Model	电压 Voltage V	频率 Frequency Hz	额定功率 Rated Power W	额定电流 Rated Current A	额定转速 Rated Speed RPM	额定转矩 Rated Torque N.m	防护等级 Grade Protection IP
Z4BLD25-220GN	220-230	50/60	25	0.40	2500	0.10	44
	100-120	50/60	25	0.80	2500	0.10	44
Z4BLD40-220GN	220-230	50/60	40	0.50	2500	0.15	44
	100-120	50/60	40	1.00	2500	0.15	44
Z4BLD60-220GN	220-230	50/60	60	0.65	2500	0.23	44
	100-120	50/60	60	1.30	2500	0.23	44

● 电机电压、功率及转速可在配件尺寸等条件下根据客户要求定制。

Motor voltage, power and speed will be customized according to this request under the allowed circumstance of adoptable dimension.

#### ■ 种类 Type

##### ● 低压电动机 Low Voltage Motor

机型 Type	型号 Model	
	齿轮轴型 Pinion Shaft	圆轴型 Round Shaft
导线型 Lead Wire Type	Z4BLD60-24GN	Z4BLD60-24A
	Z4BLD60-36GN	Z4BLD60-36A
	Z4BLD60-48GN	Z4BLD60-48A

##### ● 平行轴减速器 (另售) Parallel Shaft Gearhead (Sold Separately)

减速器种类 Gearhead Type	减速器型号 Gearhead Model	减速比 Gear Ratio
长寿命 ● 低噪音 Long Life ● Low Noise	4GN□K	3, 3.6, 5, 6, 7.5, 9, 12.5, 15, 18, 25, 30, 36, 50, 60, 75, 90, 100, 120, 150, 180, 200
		4GN10XXK (中间减速器 Decimal Gearhead)

##### ● 高压电动机 High Voltage Motor

机型 Type	型号 Model	
	齿轮轴型 Pinion Shaft	圆轴型 Round Shaft
导线型 Lead Wire Type	Z4BLD25-220GN	Z4BLD25-220A
	Z4BLD40-220GN	Z4BLD40-220A
	Z4BLD60-220GN	Z4BLD60-220A

● 减速器型号的 □ 中为减速比的数值

Enter the gear ratio in the box within the model name

## ■ 装有减速器时的容许转矩 Gear Motor-torque Table

减速器另售，中间减速器另售。

Gearhead and mid-gearbox can be sold separately

减速器型号的中为减速比的数值。

Enter the gear ratio in the box (□) within the model name.

□ 色表示与电动机同一方向旋转，其他则为相反方向。

The colored background □ indicates the same rotating direction of the motor while the rotating direction of others are opposite.

转速是以电动机额定转速为基础除以减速比而算出来的数值。实际转速将随负载大小变化而数值减少2%~20%左右。

The speed is calculated by dividing the motor's synchronous speed by the gear ratio. The actual speed is 2%~20% less than the displayed value, depending on the size of the load.

- 希望以大于下表中的减速比进行进一步减速时，可在电动机与减速机之间安装减速比为10的中间减速机。这时的容许转矩为3N·m

To reduce the speed beyond the gear ratio in the table, attach a decimal gearhead(gear ratio:10)between the gearhead and motor. In that case, the permissible torque is 3N·m.

## ■ 容许力矩单位 Allowance Torque Unit:上段 Up side(N.m) / 下段 Below side(kgf.cm)

减速比 Gear Ratio	3	3.6	5	6	7.5	9	12.5	15	18	25	30	36	50	60	75	90	100	120	150	180	200
输出轴转速 r/min Output shaft speed	1000	830	600	500	400	330	240	200	166	120	100	83	60	50	40	33	30	25	20	16	15
GL允许力矩 N.m Allowance Torque	0.46	0.56	0.77	0.93	1.16	1.39	1.72	2.06	2.47	3.00	3.61	4.33	6.01	7.22	8.00	8.00	8.00	8.00	8.00	8.00	8.00

## ■ 外形图 (单位mm) Dimensions(Unit mm)

减速器附有安装用螺丝Mounting screws are included with gearhead.

- 导线型 Lead Wiring Type

重量 Weight: 电动机 Motor; 0.8kg 减速器 Gearhead:0.8kg

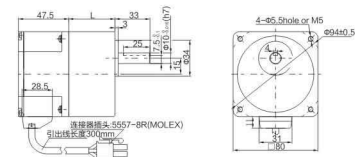

- 圆锥形的转轴部分 Shaft Section Of Round Shaft Type

除重量及轴对外电动机外形与齿轮轴型相同。  
Excluding weight and the shaft section motor shape are the same as those of the pinion shaft type.

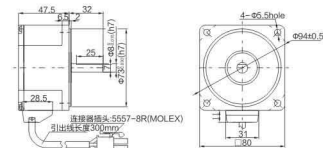

- 键 - 键槽 (减速器附件)

Key- Keyway (The Key is Included With The Gearhead)



电动机型号 Motor Model	减速器型号 Gearhead Model	减速比 Gear Ratio	L尺寸 Dimension
Z4BLD60-□GN	4GN□K	3-18	32
		25-200	41

- 减速器型号的□中为减速比的数值

Enter the gear ratio in the box (□) within the model name

- 中间减速机 Decimal Gearhead

可安装在GN轴锥轴型上。  
Can be connected to GN pinion shaft type 4GN10XK  
重量 Weight:0.41kg

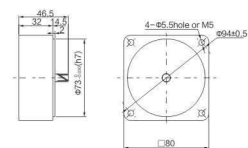

- 接线插孔对应信号说明 Wire Plughole Corresponding Signal Explanation

plug hole	1	2	3	4
signal	U	W	Hz	Hu
plug hole	5	6	7	8
signal	V	GND	Hw	Vcc

## 80系列 80 SERIES

### ■ 80L型减速器 80 L Type Reducer

#### ■ 外形图 (单位mm) Dimensions(Unit mm)

减速器附有安装用螺丝Mounting screws are included with gearhead.

- 导线型 Lead Wiring Type

重量 Weight: 电动机 Motor; 1.6kg 减速器 Gearhead:0.8kg

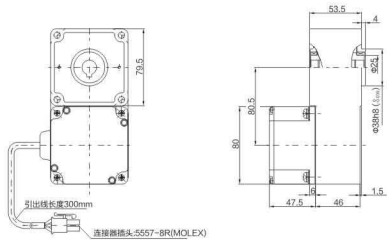

- 键 - 键槽 (减速器附件)

Key- Keyway (The Key is Included With The Gearhead)



- 接线插孔对应信号说明 Wire Plug hole Corresponding Signal Explanation

plug hole	1	2	3	4
signal	U	W	Hz	Hu
plug hole	5	6	7	8
signal	V	GND	Hw	Vcc

### ■ 80弧锥形减速器 80 Right Angle Reducer

#### ■ 外形图 (单位 mm) Dimensions(Unit mm)

减速器附有安装用螺丝Mounting screws are included with gearhead.

- 导线型 Lead Wiring Type

重量 Weight: 电动机 Motor; 1.8kg 减速器 Gearhead:0.8kg

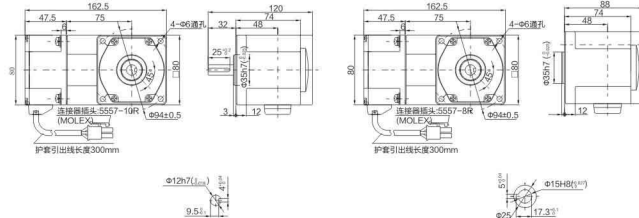



# 40W 60W 90W 120W

直流无刷减速电机 □90mm  
BLDC GEAR MOTOR

## ■ 低压无刷电机性能参数 Low Voltage Motor Parameters

型号 Model	电压 Voltage V	空载电流 No-load Current A	空载转速 No-load Speed RPM	额定功率 Rated Power W	额定电流 Rated Current A	额定转速 Rated Speed RPM	额定力矩 Rated Torque N.m	防护等级 Grade Protection IP
Z5BLD120-24□	24	0.85	4050	120	6.5	3000	0.38	20
Z5BLD120-36□	36	0.57	3900	120	4.5	3000	0.38	20
Z5BLD120-48□	48	0.45	3600	120	3.5	3000	0.38	20

## ■ 高压无刷电机性能参数 High Voltage Motor Parameters

型号 Model	电压 Voltage V	频率 Frequency Hz	额定功率 Rated Power W	额定电流 Rated Current A	额定转速 Rated Speed RPM	额定力矩 Rated Torque N.m	防护等级 Grade Protection IP
Z5BLD40-220GN	220-230	50/60	40	0.50	2500	0.15	44
	100-120	50/60	40	1.00	2500	0.15	44
Z5BLD60-220GU	220-230	50/60	60	0.70	2500	0.23	44
	100-120	50/60	60	1.40	2500	0.23	44
Z5BLD90-220GU	220-230	50/60	90	0.96	2500	0.34	44
	100-120	50/60	90	1.90	2500	0.34	44
Z5BLD120-220GU	220-230	50/60	120	1.40	2500	0.46	44
	100-120	50/60	120	2.80	2500	0.46	44

### ● 电机电压、功率及转速可在配件尺寸等条件下根据客户要求定制。

Motor voltage, power and speed will be customized according to his requirement under the allowed circumstance of adoptable dimension.

## ■ 种类 Type

### ● 低压电动机 Low Voltage Motor

机型 Type	型号Model	
	齿轮轴型 Pinion Shaft	圆轴型 Round Shaft
导线型 Lead Wire Type	Z5BLD120-24GU	Z5BLD120-24A
	Z5BLD120-36GU	Z5BLD120-36A
	Z5BLD120-48GU	Z5BLD120-48A

### ● 高压电动机 High Voltage Motor

机型 Type	型号Model	
	齿轮轴型 Pinion Shaft	圆轴型 Round Shaft
导线型 Lead Wire Type	Z5BLD40-220GU	Z5BLD40-220A
	Z5BLD60-220GU	Z5BLD60-220A
	Z5BLD90-220GU	Z5BLD90-220A
	Z5BLD120-220GU	Z5BLD120-220A

### ● 平行轴减速器（另售）Parallel Shaft Gearhead (Sold Separately)

减速器种类 Gearhead Type	减速器型号 Gearhead Model	减速比 Gear Ratio
长寿命 ● 低噪音 Long Life ● Low Noise	5GU□KB	3, 3.6, 5, 6, 7.5, 9, 12.5, 15, 18, 25, 30, 36, 50, 60, 75, 90, 100, 120, 150, 180, 200
	5GU10XK(中间减速器 Decimal Gearhead)	

### ● 减速器型号的□中为减速比的数值

Enter the gear ratio in the box within the model name

## ■ 装有减速器时的容许转矩 Gear Motor-torque Table

减速器另售：中间减速器另售。

Gearhead and mid-gearbox can be sold separately

减速器型号的□中为减速比的数值。

Enter the gear ratio in the box (□) within the model name.

□表示与电动机同一方向旋转，其他则为相反方向。

The colored background (□) indicates the same rotating direction of the motor while the rotating direction of others are opposite.

转速是以电动机的额定转速为基准除以减速比而算出来的数值。实际转速将负载大小变化而所示数值减少2%~20%左右。

The speed is calculated by dividing the motor's synchronous speed by the gear ratio. The actual speed is 2%~20% less than the displayed value, depending on the size of the load.

### ● 希望以下大于表的减速比进行进一步减速时，可在电动机与减速机之间安装减速比为10的中间减速机。这时的容许转矩为3N·m

To reduce the speed beyond the gear ratio in the table, attach a decimal gearhead(gear ratio:10) between the gearhead and motor. In that case, the permissible torque is 3N·m.

## ■ 容许力矩单位 Allowance Torque Unit:上段 Up side(N.m) / 下段 Below side(kgf.cm)

减速比 Gear Ratio	3	3.6	5	6	7.5	9	12.5	15	18	25	30	36	50	60	75	90	100	120	150	180	200
输出轴转速 r/min Out put shaft speed	1000	830	600	500	400	330	240	200	166	120	100	83	60	50	40	33	30	25	20	16	15
GU允许力矩 N.m Allowance Torque	0.92	1.10	1.54	1.86	2.32	2.78	3.44	4.12	4.94	6.00	7.22	8.66	12.60	14.4	18.0	19.9	20.0	20.0	20.0	20.0	20.0

## ■ 外形图（单位mm）Dimensions(Unit mm)

减速器将用安装螺丝Mounting screws are included with gearhead.

- 导线型 Lead Wiring Type  
重量 Weight: 电动机 Motor: 1.3kg 减速器: Gearhead 1.5kg

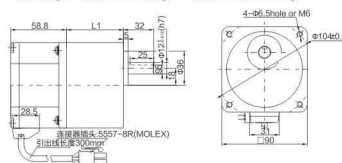

### ● 圆轴型的转轴部分 Shaft Section Of Round Shaft Type

除重量及轴部外形电动机轴与齿轮轴型相同。

Excluding weight and the shaft section motor shape are the same as those of the pinion shaft type.

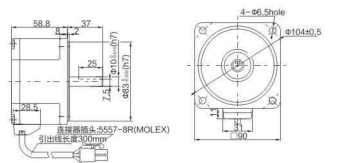

### ● 键 - 键槽（减速器附件）

Key - Keyway (The Key is Included With The Gearhead)



电动机型号 Motor Model	减速器型号 Gearhead Model	减速比 Gear Ratio	L尺寸 Dimension
Z5BLD120-□□□	5GU□KB	3-200	65.5

### ● 减速器型号的□中为减速比的数值

Enter the gear ratio in the box (□) within the model name

### ● 中间减速器 Decimal Gearhead

可安装在GN齿轮轴型上

Can be connected to GN pinion shaft type 5GN10XK

重量 Weight: 0.65kg

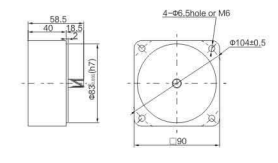

### ● 接线孔对应信号说明 Wire Plug hole Corresponding Signal Explanation

plug hole	1	2	3	4
signal	U	W	Hz	Hu
plug hole	5	6	7	8
signal	V	GND	Hw	Vcc



## 90系列 90 SERIES

### ■ 90L型减速器 90 L Type Reducer

#### ■ 外形图 (单位mm) Dimensions(Unit mm)

减速器附有安装用螺丝 Mounting screws are included with gearhead.

#### ● 导线型 Lead Wiring Type

重量 Weight: 电动机 Motor; 2.0kg 减速器; Gearhead1.5kg

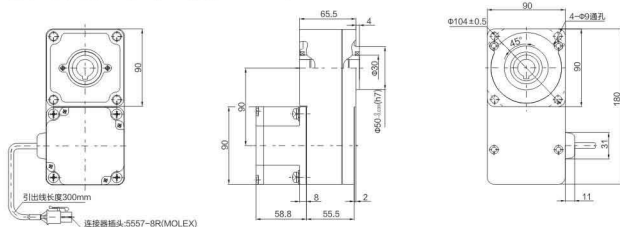

#### ● 键·键槽 (减速器附件)

Key·Keyway (The Key is Included With The Gearhead)



#### ● 接线孔对应信号说明 Wire Plug Hole Corresponding Signal Explanation

plug hole	1	2	3	4
signal	U	W	Hz	Hu
plug hole	5	6	7	8
signal	V	GND	Hw	Vcc

### ■ 90弧锥形减速器 90 Right Angle Reducer

#### ■ 外形图 (单位 mm) Dimensions(Unit mm)

减速器附有安装用螺丝 Mounting screws are included with gearhead.

#### ● 导线型 Lead Wiring Type

重量 Weight: 电动机 Motor; 2.8kg 减速器 Gearhead; 1.5kg

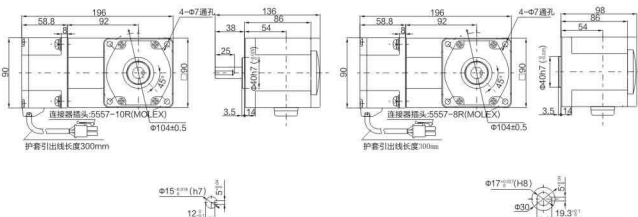

# 400W

直流无刷减速电机 □104mm  
BLDC GEAR MOTOR

### ■ 低压无刷电机性能参数 Low Voltage Motor Parameters

型号 Model	电压 Voltage V	空载电流 No-load Current A	空载转速 No-load Speed RPM	额定功率 Rated Power W	额定电流 Rated Current A	额定转速 Rated Speed RPM	额定力矩 Rated Torque N.m	防护等级 Grade Protection IP
Z6BLD400-48GU	48	1.50	3800	400	10.5	3000	1.27	20

### ■ 高压无刷电机性能参数 High Voltage Motor Parameters

型号 Model	电压 Voltage V	频率 Frequency Hz	额定功率 Rated Power W	额定电流 Rated Current A	额定转速 Rated Speed RPM	额定力矩 Rated Torque N.m	防护等级 Grade Protection IP
Z6BLD400-220GU	220-230	50/60	400	3.50	2500	1.50	44
	100-120	50/60	400	7.10	2500	1.50	44

#### ● 电机电压、功率及转速可在配件尺寸等条件下根据客户要求定制。

Motor voltage, power and speed will be customized according to his request under the allowed circumstance of adoptable dimension.

### ■ 种类 Type

#### ● 低压电动机 Low Voltage Motor

机型 Type	型号Model	
	齿轮轴型 Pinion Shaft	圆轴型 Round Shaft
导线型 Lead Wire Type	Z6BLD400-48GU	Z6BLD400-48A

#### ● 高压电动机 High Voltage Motor

机型 Type	型号Model	
	齿轮轴型 Pinion Shaft	圆轴型 Round Shaft
导线型 Lead Wire Type	Z6BLD400-110GU	Z6BLD400-220A
	Z6BLD400-220GU	Z6BLD400-220A

#### ● 平行轴减速器 (另售) Parallel Shaft Gearhead (Sold Separately)

减速器种类 Gearhead Type	减速器型号 Gearhead Model	减速比 Gear Ratio
长寿命●低噪音 Long Life●Low Noise	6GU□KB	3, 3.6, 5, 6, 7.5, 9, 12.5, 15, 18, 25, 30, 36, 50, 60, 75, 90, 100, 120, 150, 180, 200
	6GU10XK(中间减速器 Decimal Gearhead)	

#### ● 减速器型号的□中为减速比的数值

Enter the gear ratio in the box within the model name

■ 装有减速器时的容许转矩 Gear Motor-torque Table

减速器另售，中间减速器另售。  
Gearhead and mid-gearbox can be sold separately  
减速器型号中的方格为减速比的数值。  
Enter the gear ratio in the box ( ) within the model name.

□ 色表示与电动机同一方向旋转，其他则为相反方向。  
The colored background □ indicates the same rotating direction of the motor while the rotating direction of others are opposite.  
转速以电动机额定转速为基准除以减速比而算出来的数值。实际转速将随负载大小变化而比所示数值减少2%~20%左右。  
The speed is calculated by dividing the motor's synchronous speed by the gear ratio. The actual speed is 2%~20% less than the displayed value, depending on the size of the load.

希望以大于下表中的减速比进行进一步减速时，可在电动机与减速机之间安装减速比为10的中间减速机。这时的容许转矩为3N·m  
To reduce the speed beyond the gear ratio in the table, attach a decimal gearhead(gear ratio:10)between the gearhead and motor.  
In that case, the permissible torque is 3N·m.

■ 容许力矩单位 Allowance Torque Unit:上段 Up side(N·m) / 下段 Below side(kgf·cm)

减速比 Gear Ratio	3	3.6	5	6	7.5	9	12.5	15	18	25	30	36	50	60	75	90	100	120	150	180	200
输出转速 r/min Output shaft speed	833	694	500	416	333	277	200	167	139	100	83	69	50	42	33	28	25	21	17	14	12.5
允许力矩 N·m Allowance Torque	3.09	3.71	5.16	6.17	7.74	9.28	11.62	13.94	16.73	20.0	20.0	20.0	20.0	20.0	20.0	20.0	20.0	20.0	20.0	20.0	20.0

■ 外形图 (单位mm) Dimensions(Unit mm)

减速器附有安装用螺丝Mounting screws are included with gearhead.

● 导线型 Lead Wiring Type

重量 Weight; 电动机 Motor; 2.5kg 减速机; Gearhead 2.1kg

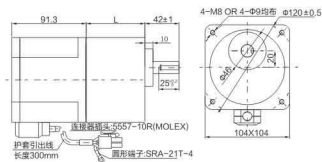

电动机型号 Motor Model	减速机型号 Gearhead Model	减速比 Gear Ratio	L尺寸 Dimension
ZBLD400-□GU	6GU□KB	3~200	72

● 减速器型号的□中为减速比的数值  
Enter the gear ratio in the box (□) within the model name

● 圆锥形的转轴部分 Shaft Section Of Round Shaft Type

除重量及轴部外形与齿轮轴型相同。  
Excluding weight and the shaft section motor shape are the same as those of the pinion shaft type.

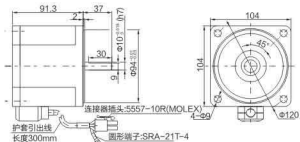

● 键·键槽 (减速器附件)

Key·Keyway (The Key is Included With The Gearhead)



● 接线插孔对应信号说明 Write Plughole Corresponding Signal Explanation



排线对应的意义									
1	2	3	4	5	6	7	8	9	10
蓝 (L)	黄 (W)	灰 (U)	绿 (Hv)	棕 (V)	棕 (Hw)	金属丝网	棕 (Vcc)	白 (GND)	白 (Vcc)
W	Hu	U	Hv	V	Hw		Vcc+5V	GND	Vcc

104系列  
104 SERIES

■ 104L型减速机 104 L Type Reducer

■ 外形图 (单位mm) Dimensions(Unit mm)

减速器附有安装用螺丝Mounting screws are included with gearhead.

● 导线型 Lead Wiring Type

重量 Weight; 电动机 Motor; 4.3kg 减速机; Gearhead; 2.1kg

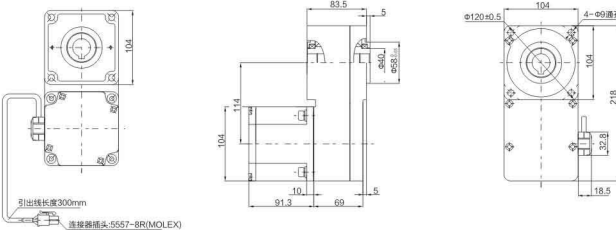

● 键·键槽 (减速器附件)

Key·Keyway (The Key is Included With The Gearhead)



● 接线插孔对应信号说明 Write Plug hole Corresponding Signal Explanation

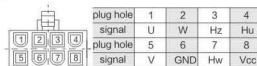

■ 104弧锥形减速机 104 Right Angle Reducer

■ 外形图 (单位mm) Dimensions(Unit mm)

减速器附有安装用螺丝Mounting screws are included with gearhead.

● 导线型 Lead Wiring Type

重量 Weight; 电动机 Motor; 4.3kg 减速机 Gearhead; 2.1kg

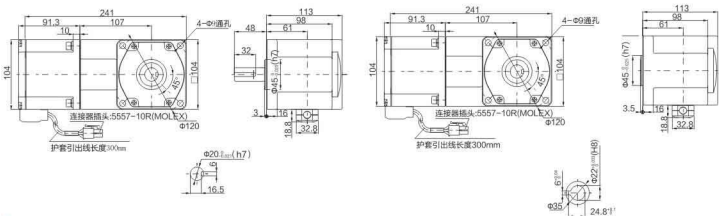

● 接线插孔对应信号说明 Write Plug hole Corresponding Signal Explanation

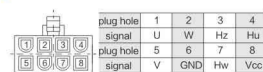

## 通用规格 COMMON SPECIFICATIONS

### ■ 电动机的容许悬挂负载·容许轴向负载 Permissible Overhung Load And Permissible Thrust Load Of Motor

容许悬挂负载 Permissible Overhung Load

电动机Motor		容许悬挂负载 Permissible Overhung Load	
安装尺寸 Motor Frame Size □(mm)	输出轴直径 Output Shaft Diameter □(mm)	距轴端的距离 Distance from Shaft End	
		10mm	10mm
42	5	40	—
60	6	50	110
70	6	40	60
80	8	50	140
90	10	110	120
	12	140	200
100	12	240	270
	14	320	350

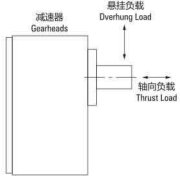

容许轴向负载。

Permissible Thrust Load.

请尽量不要施加轴向负载。即使不得已的情况下，请将轴向负载控制在电动机重量的一半以下。  
Avoid thrust loads as much as possible. If thrust load is unavoidable, keep it to half or less of the motor mass.

### ■ 电动机的容许悬挂负载·容许轴向负载 Permissible Overhung Load And Permissible Thrust Load Of Motor

型号 Model	减速比 Gear Ratio	最大容许转矩 Maximum Permissible Torque N·m	容许悬挂负载 Permissible Overhung Load N		容许轴向 Permissible Thrust Load N
			距轴端10mm 10mm from Shaft End	距轴端20mm 20mm from Shaft End	
0GN_ K	3-60	1.0	20	—	15
	3-18		50	80	
	25-200		120	180	
3GN_ K	3-18	5.0	80	120	40
	25-200		150	250	
	3-18		100	150	
4GN_ K	3-18	8.0	200	300	50
	25-200		250	350	
	3-18		300	450	
5GN_ K	3-18	10	400	500	100
	25-200		450	600	
	3-9		500	700	
5GU_ KB 5GU_ K	11.5-18	20	500	700	150
	25-200		500	700	
	3-200		1100	1500	

### ■ 减速器的容许负载惯性惯量J Permissible Load Inertia for Gearhead J

连接到减速器上的负载惯性惯量(J)较大的情况下，在频繁的间歇运转的启动瞬间(或以电磁制动及制动器进行急停时)会出现瞬间较大的转矩。该冲击负载过大导致减速器及电动机损坏。

When a high load inertia (J) is connected to a gearhead, high torque is exerted instantaneously on the gearhead when starting up in frequent, discontinuous operations (or when stopped by an electromagnetic brake, or when stopped instantaneously by a brake pack).

Excessive impact loads can cause the gearhead or motor damage.

下面列出了电动机轴上的容许负载惯性的值，使用时请控制在此数值下。三相电动机的容许负载惯性惯量是指从一旦停止运转后再进行反转时的数值。

The table below gives values for permissible load inertia on the motor shaft. Use the motor and gearhead within these parameters. The permissible inertia load value shown for three-phase motors is the value when reversing after a stop.

请利用下面的公式计算减速器输出轴上的容许惯性惯量(J)。

The permissible load inertia (J) on the gearhead output shaft is calculated with the following equation.

通过带电磁制动电动机、制动器及速度控制电动机的瞬时停止来运转容许负载惯性惯量时的使用寿命为200万次。

The life of the gearhead when operating at the permissible inertia load with instantaneous stops of the motors with electromagnetic brakes, brake packs or speed control motors is at least 2 million cycles.

### ■ 减速器输出轴上的容许负载惯性惯量 Permissible Load Inertia For Gearhead Output Shaft

减速比1/3 ~ 1/50时 JG=JM×1

减速比1/60以上时 JG=JM×2.500

Gear ratio 1/3 ~ 1/50 JG=JM×1

Gear ratio 1/60 or high JG=JM×1

JG: 减速器输出轴容许负载惯性惯量J(×10 kg·m<sup>2</sup>)JM: 减速器输出轴容许负载惯性惯量J(×10 kg·m<sup>2</sup>)

I: 减速比例: 减速比(3时=3)

JG: Permissible load inertia gearhead output shaft J(×10 kg·m<sup>2</sup>)JM: Permissible load inertia at the motor shaft J(×10 kg·m<sup>2</sup>)

I: Gear ratio (Example: 1:3 means the gear ratio of 1/3)

### ■ 电动机轴上的容许负载惯性惯量 Permissible Load Inertia At The Motor Shaft

电动机电源相数 No. of Phase	安装尺寸 Motor Frame Size	输出功率 Output Power	电动机轴上的容许负载惯性惯量 Permissible Load Inertia at the Motor Shaft		
			J(×10 <sup>-4</sup> kg·m <sup>2</sup> )	GD <sup>2</sup> (kg·m <sup>2</sup> )	
单相 Single-phase	42	1W、3W	0.016	0.07	
		3W※、6W	0.062	0.25	
		6W※、15W	0.14	0.52	
		10W※、25W	0.31	1.2	
		20W※、40W	0.75	3	
		80W	1.1	4.6	
	90	90W	1.1	4.6	
		120W	1.1	4.6	
		120W	2	8	
		140W	2	8	
		180W	2	8	
		200W	0.062	0.25	
三相 Three-phase	70	15W	0.14	0.52	
		25W	0.31	1.2	
		40W	0.75	3	
		80W	1.1	4.6	
		90W	1.1	4.6	
		120W	1.1	4.6	
	90	120W	2	8	
		140W	2	8	
		180W	2	8	
		200W	2	8	
		60	6W	0.062	0.25
		15W	0.14	0.52	
直流 DC Power	70	25W、40W	0.31	1.2	
		40W	0.75	3	
		40W	0.75	3	
		40W	1.1	4.6	
		60W	1.1	4.6	
		90W	1.1	4.6	
	90	120W	1.1	4.6	
		120W	1.1	4.6	
		120W	1.1	4.6	
		120W	1.1	4.6	
		120W	1.1	4.6	
		250W	2	8	

※是指转矩电动机的输出功率

※Output power for torque motors

### ■ 减速器容许转矩的计算 The Calculation For The Permissible Torque Of Gearhead

部分机型并未列在容许转矩表上，需要时可按下公式计算。

Permissible torque for some products are omitted. In that case, use the equation below to calculate the permissible torque.

容许转矩 Permissible Torque TG=TM×η

TG: 减速器容许转矩 Permissible Torque of Gearhead

I: 减速器减速比 Gear Ratio Gearhead

TM: 电动机转矩 Motor Torque

η: 减速器传动效率 Gearhead Efficiency

### ■ 减速器传动效率 Gearhead Efficiency

型号Model	减速比Gear Ratio																			
	3	3.6	5	6	7.5	9	12.5	15	18	25	30	36	50	60	75	90	100	120	150	200
0GN_ K 2GN_ K 3GN_ K 4GN_ K 5GN_ K	81%										73%			66%						
5GU_ KB(K) 6GU_ K	81%								73%				66%				59%			

## 选购配件 ACCESSORIES

### ■ 电动机·减速器用安装底座 Motor / Gearhead Mounin Brackets

便于安装固定电动机、减速器的专用高强度产品。安装底座上已有螺孔，请用减速器附带的螺丝来组合电动机与减速器。安装电动机单件时，请另用安装用螺丝。Mounting Brackets for attaching and securing a motor and gearhead. They are high-strength type, which can be used with high power motors / gearheads. These brackets come with tapped holes. To mount the motor and gearhead, simply fasten with screws provided to the gearhead. To mount the motor alone, mounting screws must be provided separately.



### ■ 安装尺寸70mm用 Motor Frame Size:70mm

型号Model: ZD3MS 重量Weight: 160g 材质Material: 铝合金Aluminum  
适用产品Applicable Products: 3GN减速器3GN Gearhead  
安装尺寸□70mm电动机Motor with the frame size of □70mm

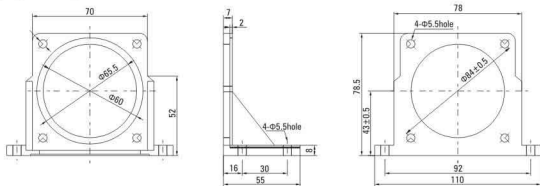

### ■ 安装尺寸80mm用 Motor Frame Size:80mm

型号Model: ZD4MS 重量Weight: 200g 材质Material: 铝合金Aluminum  
适用产品Applicable Products: 4GN减速器4GN Gearhead  
安装尺寸□80mm电动机Motor with the frame size of □80mm

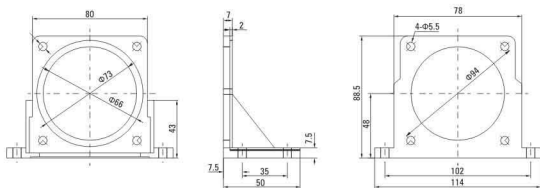

### ■ 安装尺寸90mm用 Motor Frame Size:90mm

型号Model: ZD5MS 重量Weight: 270g 材质Material: 铝合金Aluminum  
适用产品Applicable Products: 5GN、5GU减速器5GN、5GU Gearhead  
安装尺寸□90mm电动机Motor with the frame size of □90mm

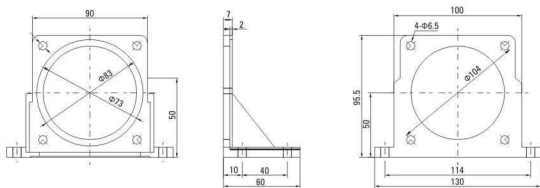

### ■ 安装尺寸80、90、104mm用 Motor Frame Size:80、90、104mm

型号Model: ZD6MS 重量Weight: 260g 材质Material: 铝合金Aluminum  
适用产品Applicable Products: 4GN减速器4GN Gearhead  
安装尺寸□80、90、104mm电动机Motor with the frame size of □80、90、104mm

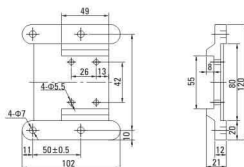

### ■ 电动机用端子箱 Terminal Box For Motor

根据客户的需求，可选择以下类型的端子箱。  
You can select from following types of terminal boxes according to customer's request.

型号Model: ZDTX  
重量Weight: 90g 材质Material: 铝合金Aluminum  
适用产品Applicable Products: 4GN减速器4GN Gearhead  
安装尺寸□80、90、104mm电动机  
Motor with the frame size of □80、90、104mm



■ 适用电缆直径为 Use cable with a diameter of  $\Phi 4-8\Phi$ mm

型号Model: ZDTX  
重量Weight: 290g 材质Material: 铝合金Aluminum  
适用产品Applicable Products: 4GN减速器4GN Gearhead  
安装尺寸□80、90、104mm电动机  
Motor with the frame size of □80、90、104mm

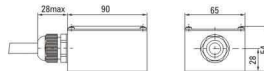

■ 适用电缆直径为 Use cable with a diameter of  $\Phi 4-8\Phi$ mm